

B1
INSTALLATION
DRAWING

IF THIS DOCUMENT IS PRINTED IN HARDCOPY,
IT IS FOR INFORMATION USE ONLY AND THEREFORE
IS NOT SUBJECT TO UPDATING CONTROLS. ALWAYS
REFER TO SOLIDWORKS VIEWER FOR LATEST ISSUE



THIS DRAWING IS CONFIDENTIAL AND IS SUPPLIED ON THE EXPRESS CONDITION THAT
IT SHALL NOT BE LOANED OR COPIED OR DISCLOSED TO ANY OTHER PERSON OR USED
FOR ANY OTHER PURPOSE WITHOUT THE WRITTEN CONSENT OF AP RACING LTD.



AP Racing
Wheler Road
Coventry
CV3 4LB

Tel: +44 024 7663 9595
Fax: +44 024 7663 9559
e-mail: sales@apracings.co.uk
Web site: HTTP://www.apracings.com

© AP Racing Ltd. 2005

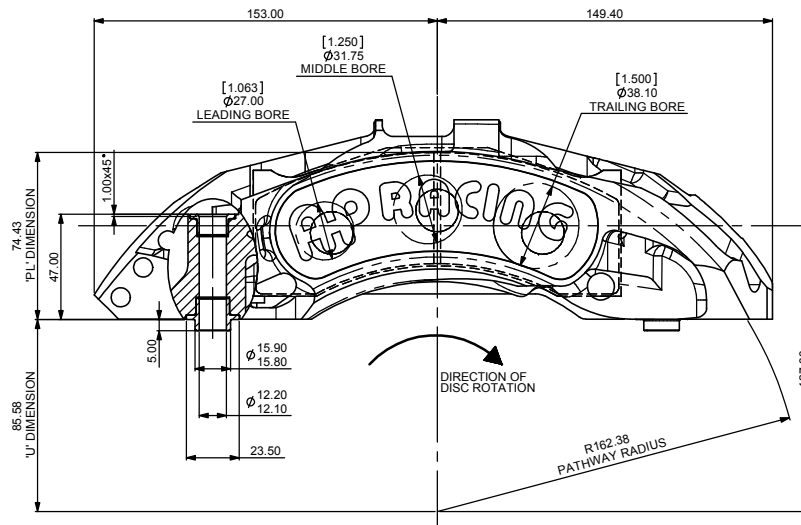
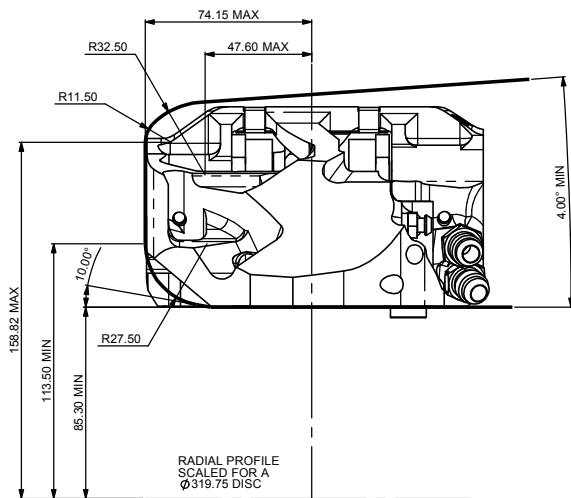

GENERAL DESCRIPTION
LIQUID COOLED 6 PISTON DIFFERENTIAL BORE CALIPER
TO SUIT UP TO 319.75 x 32.0 IRON DISC. THE CALIPERS
INCLUDE HIGH TEMPERATURE SEALS & WIPER SEALS.

APPLICATION
RALLY RAID CALIPER

TECHNICAL INFORMATION
TOTAL PISTON AREA: 50cm²
PISTON MATERIAL: STAINLESS STEEL
BODY MATERIAL: ALUMINIUM ALLOY
ASSEMBLY WEIGHT (LESS PADS): 2.9kg (EST)
ANTI-KNOCK BACK SPRINGS: 7lbs (AS STANDARD)

INSTALLATION INFORMATION
DISC & CALIPER MOUNTING TOLERANCES TO BE SUCH
THAT THE DISC IS CENTRAL TO THE CALIPER TO WITHIN
±0.5mm.
DISC DIAMETRAL CLEARANCE SHOULD BE 2.5mm NOMINAL
FROM DISC O/D TO PATHWAY.

KEY TO DIMENSIONS
'PL' DIMN : TOP OF PAD MATERIAL TO MOUNTING BOSS
FACE, WITH PAD SITTING DOWN ON LEDGE.
'U' DIMN = WHEEL CENTRE LINE TO CALIPER MOUNTING
BOSS FACE = (DISC Ø/2) - PL DIMN

AP RACING TECHNICAL SECTION WILL BE PLEASED TO
ADVISE ON THE MOST SUITABLE EQUIPMENT FOR ANY
PARTICULAR APPLICATION.

CALIPER PART NUMBERS
CP6768-2S7L - RIGHT HAND TRAILING (BEHIND AXLE)
CP6768-3S7L - LEFT HAND TRAILING (BEHIND AXLE)

CP4518-CEJ:RAID - SEAL REPAIR KIT

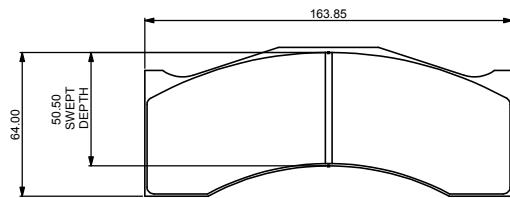

CP6766D50 PAD

PAD THICKNESS - 18.0 mm
PAD AREA - 81.9 cm²
PAD VOLUME - 147.42 cm³

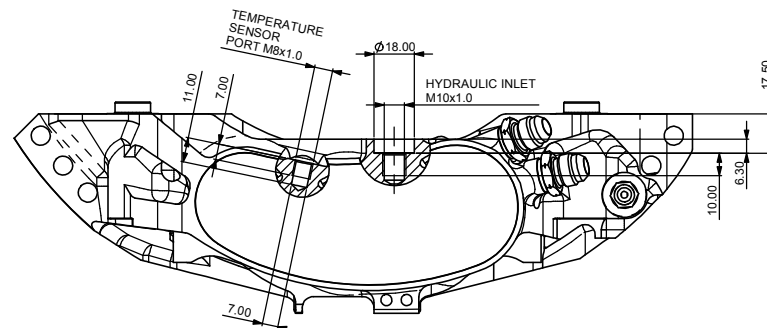
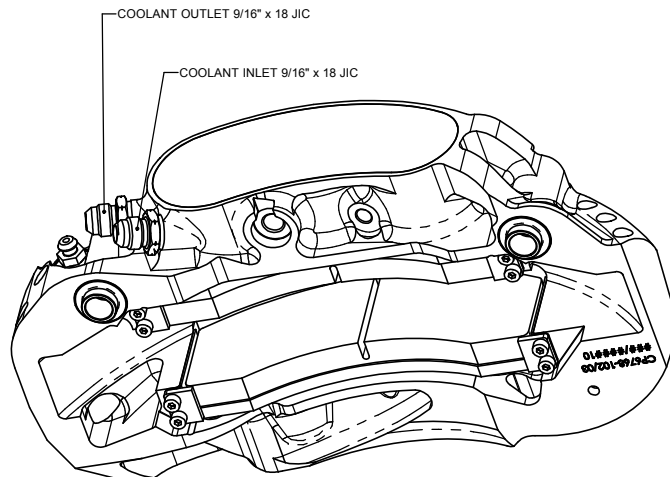
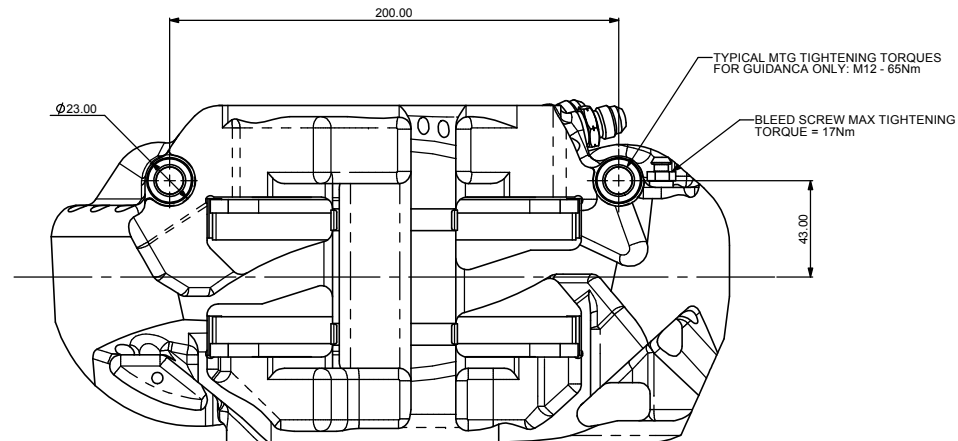

Rev	Date & No.	Alterations		Zone	Initials
		Particulars	#		
1	23/04/10 B5906	FIRST ISSUE			JH
2	30/04/10 B5906.04	TEMP SENSOR PORT DETAIL ADDED	C10		JH

SCALE 1:1	SHEET 1 OF 2
DRAWN heritage	
APPROVED	
DERIVED FROM	
TITLE 6-POT RALLY RAID CALIPER	
DRG NO.	cp6768-1cd

INSTALLATION DRAWING

IF THIS DOCUMENT IS PRINTED IN HARDCOPY,
IT IS FOR INFORMATION USE ONLY AND THEREFORE
IS NOT SUBJECT TO UPDATING CONTROLS. ALWAYS
REFER TO SOLIDWORKS VIEWER FOR LATEST ISSUE



FIRST ANGLE
PROJECTION

THIS DRAWING IS CONFIDENTIAL AND IS SUPPLIED ON THE EXPRESS CONDITION THAT IT SHALL NOT BE LOANED OR COPIED OR DISCLOSED TO ANY OTHER PERSON OR USED FOR ANY OTHER PURPOSE WITHOUT THE WRITTEN CONSENT OF AP RACING LTD.



AP Racing
Wheler Road
Coventry
CV3 4LB

Tel: +44 024 7663 9595
Fax: +44 024 7663 9559
e-mail: sales@apracing.co.uk
Web site: [HTTP://www.apracing.com](http://www.apracing.com)

[illegible]

SCALE 1:1	SHEET 1 OF 2	
DRAWN	heritage	
APPROVED		
DERIVED FROM		
TITLE		
6-POT RALLY RAID CALIPER		

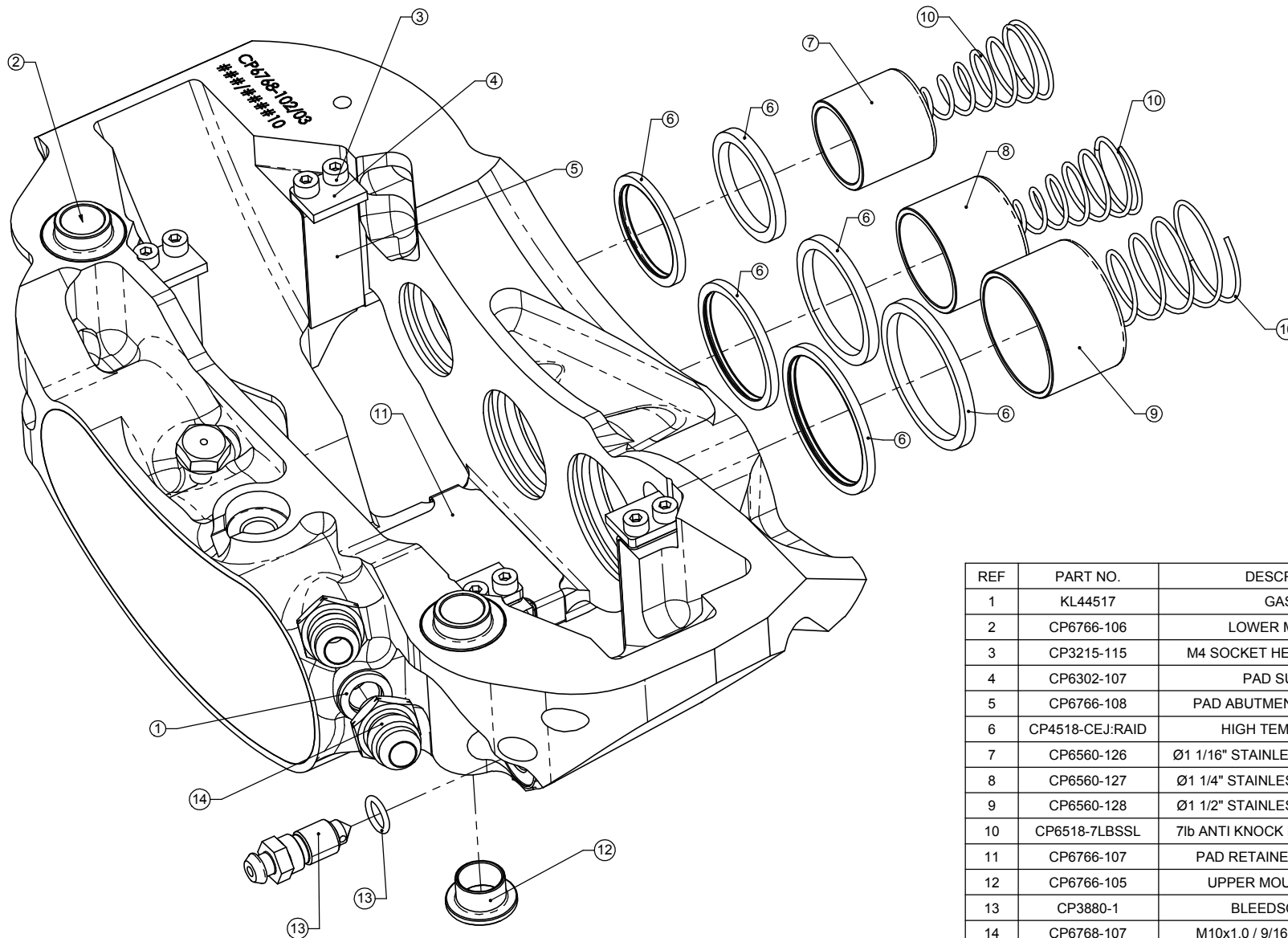

REF	PART NO.	DESCRIPTION	QTY
1	KL44517	GASKET	2
2	CP6766-106	LOWER MTG BOSS	2
3	CP3215-115	M4 SOCKET HEAD CAP SCREW	8
4	CP6302-107	PAD SUPPORT	4
5	CP6766-108	PAD ABUTMENT WEARPLATE	4
6	CP4518-CEJ:RAID	HIGH TEMP SEAL KIT	1
7	CP6560-126	Ø1 1/16" STAINLESS STEEL PISTON	2
8	CP6560-127	Ø1 1/4" STAINLESS STEEL PISTON	2
9	CP6560-128	Ø1 1/2" STAINLESS STEEL PISTON	2
10	CP6518-7LBSSL	7lb ANTI KNOCK BACK SPRING KIT	1
11	CP6766-107	PAD RETAINER WEARPLATE	4
12	CP6766-105	UPPER MOUNTING BOSS	2
13	CP3880-1	BLEEDSCREW KIT	1
14	CP6768-107	M10x1.0 / 9/16" JIC ADAPTOR	2