

# B1 INSTALLATION DRAWING

IF THIS DOCUMENT IS PRINTED IN HARDCOPY, IT IS FOR INFORMATION USE ONLY AND THEREFORE IS NOT SUBJECT TO UPDATING CONTROLS. ALWAYS REFER TO SOLIDWORKS VIEWER FOR LATEST ISSUE



THIS DRAWING IS CONFIDENTIAL AND IS SUPPLIED ON THE EXPRESS CONDITION THAT IT SHALL NOT BE LOANED OR COPIED OR DISCLOSED TO ANY OTHER PERSON OR USED FOR ANY OTHER PURPOSE WITHOUT THE WRITTEN CONSENT OF AP RACING LTD.

**AP RACING**  
 Wheler Road  
 Coventry  
 CV3 4LB  
 Tel: +44 024 7663 9595  
 Fax: +44 024 7663 9559  
 e-mail: sales@apracings.co.uk  
 Web site: HTTP://www.apracings.com

© AP Racing Ltd. 2005

Alterations			
Date & No.	Particulars	Zone	Initials

1	16/07/10 B5692	FIRST ISSUE	JH
---	----------------	-------------	----

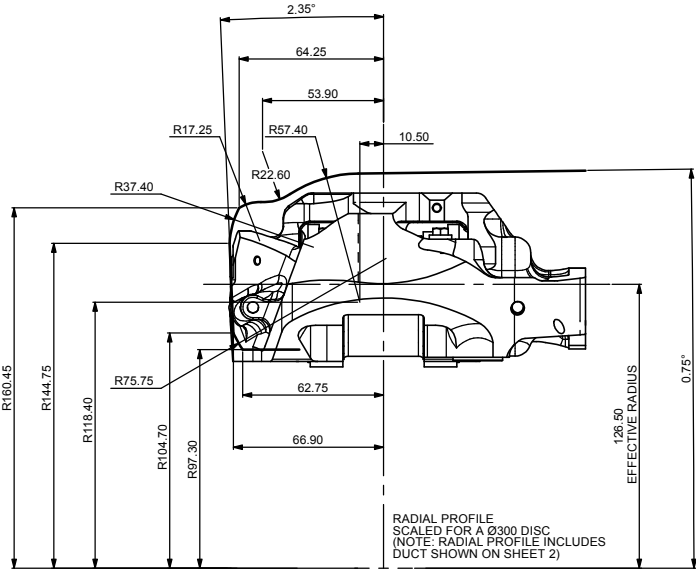

RADIAL PROFILE SCALED FOR A Ø300 DISC (NOTE: RADIAL PROFILE INCLUDES DUCT SHOWN ON SHEET 2)

GENERAL DESCRIPTION:  
 4 PISTON DIFFERENTIAL BORE CALIPER TO SUIT UP TO Ø355 x 32 IRON DISC

APPLICATION:  
 S2000 RALLY - FRONT

TECHNICAL INFORMATION:  
 TOTAL PISTON AREA: 45.9cm<sup>2</sup>  
 PISTON MATERIAL: STAINLESS STEEL  
 BODY MATERIAL: ALUMINIUM ALLOY  
 APPROXIMATE ASSEMBLY WEIGHT: 2.11Kg

INSTALLATION INFORMATION:  
 DISC & CALIPER MOUNTING TOLERANCES TO BE SUCH THAT THE DISC IS CENTRAL TO THE CALIPER TO WITHIN 20.5mm  
 CALIPER TO BE MOUNTED WITHIN ±15° FROM VERTICAL  
 DISC DIAMETRAL CLEARANCE SHOULD BE 2.5mm NOM. FROM DISC O.D. TO PATHWAY  
 BLEED SCREW MAX. TIGHTENING TORQUE 17Nm

KEY TO DIMENSIONS:  
 PL: TOP OF PAD MATERIAL TO MOUNTING BOSS FACE WITH PAD SITTING DOWN ON LEDGE.

CALIPER PART NUMBERS  
 CP6830-SS4LP - RIGHT HAND LEADING (IN FRONT OF AXLE)  
 CP6830-SS4LP - LEFT HAND LEADING (IN FRONT OF AXLE)

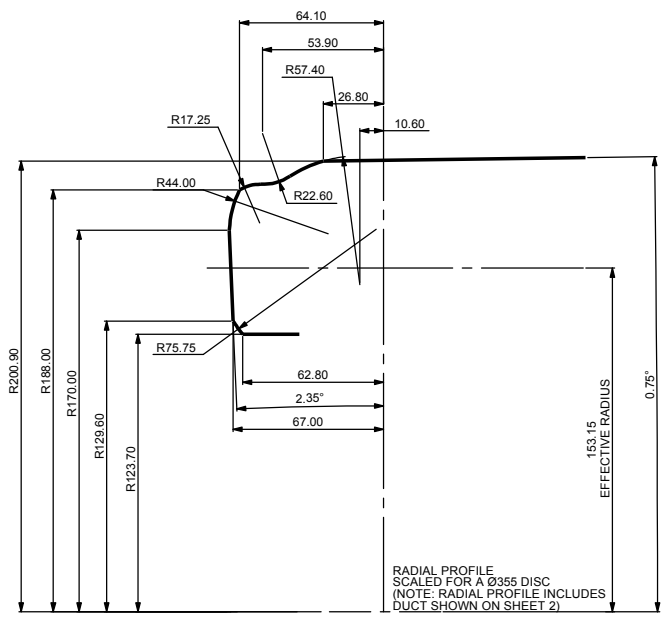
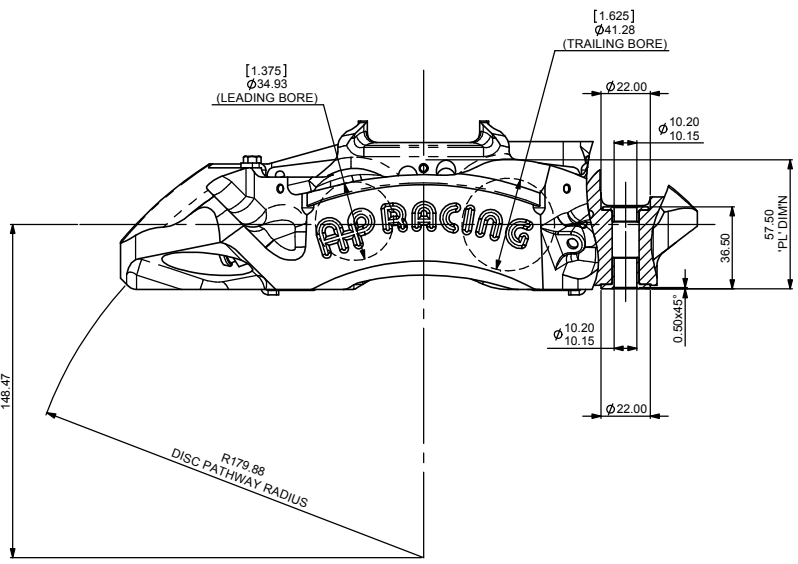

RADIAL PROFILE SCALED FOR A Ø355 DISC (NOTE: RADIAL PROFILE INCLUDES DUCT SHOWN ON SHEET 2)

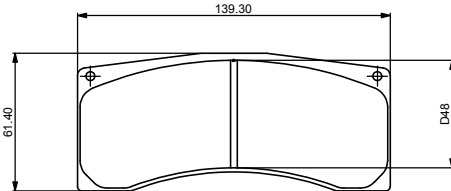

CP6820D48 FAMILY IRON PAD  
 AREA - 63.2CM<sup>2</sup>  
 THICKNESS - 1.6CM  
 VOLUME - 69.5CM<sup>3</sup>

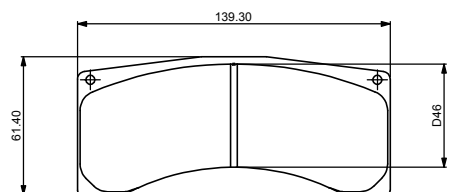

CP6820D46 FAMILY IRON PAD  
 AREA - 61.7CM<sup>2</sup>  
 THICKNESS - 1.6CM  
 VOLUME - 67.9CM<sup>3</sup>

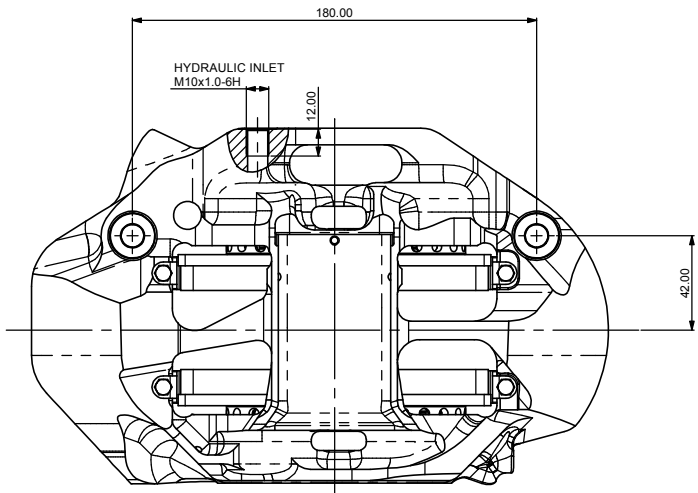

SCALE 1:1	SHEET 1 OF 3
DRAWN heritage	
APPROVED	
DERIVED FROM	
TITLE	
4-POT S2000 RALLY CALIPER INSTALLATION DRAWING	
DRG NO.	CP6830-10CD

# B1 INSTALLATION DRAWING

IF THIS DOCUMENT IS PRINTED IN HARDCOPY, IT IS FOR INFORMATION USE ONLY AND THEREFORE IS NOT SUBJECT TO UPDATING CONTROLS. ALWAYS REFER TO SOLIDWORKS VIEWER FOR LATEST ISSUE



THIS DRAWING IS CONFIDENTIAL AND IS SUPPLIED ON THE EXPRESS CONDITION THAT IT SHALL NOT BE LOANED OR COPIED OR DISCLOSED TO ANY OTHER PERSON OR USED FOR ANY OTHER PURPOSE WITHOUT THE WRITTEN CONSENT OF AP RACING LTD.



AP Racing  
Wheler Road  
Coventry  
CV3 4LB  
Tel: +44 024 7663 9595  
Fax: +44 024 7663 9559  
e-mail: sales@apracing.co.uk  
Web site: HTTP://www.apracing.com  
© AP Racing Ltd. 2005

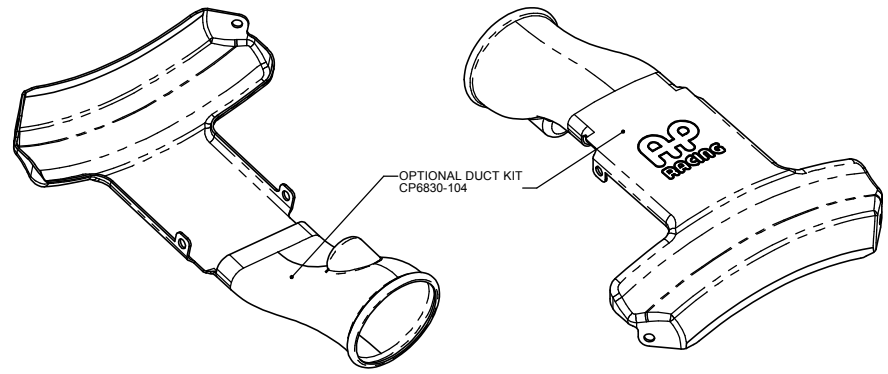

OPTIONAL DUCT KIT  
CP6830-104

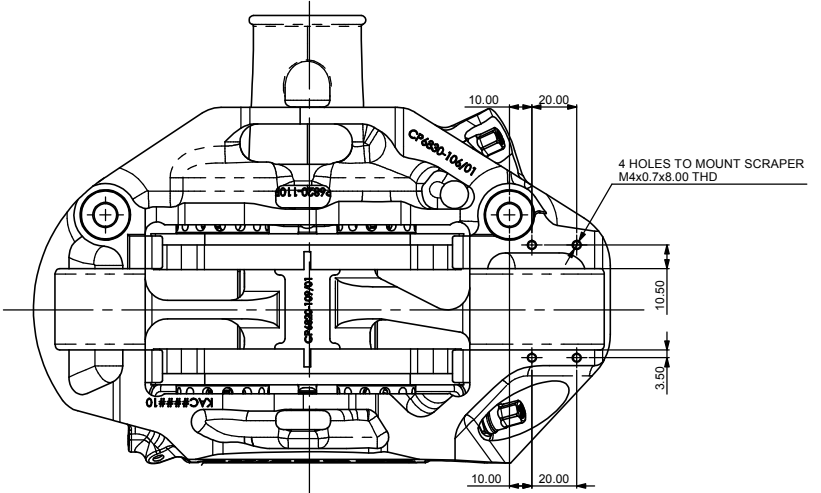

THE RECESS IN THE DUCT CAN BE COVERED WITH DUCK TAPE OR SIMILAR ONCE THE SCREW HAS BEEN FITTED TO CREATE A SMOOTH SURFACE FOR THE AIR FLOW

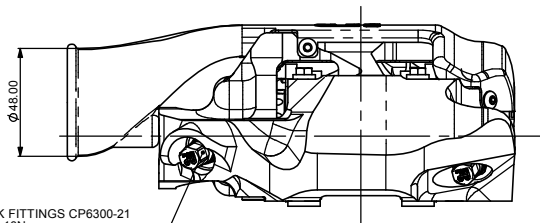

OPTIONAL DRY BREAK FITTINGS CP6300-21  
TIGHTENING TORQUE 13Nm  
DRY BREAK TO BE USED IN CONJUNCTION WITH CP6300-7 BLEED SYSTEM FITTING. FOR FURTHER DRY BREAK INFORMATION & SPARES REFER TO CP6300-13CD INSTALLATION DRAWING.

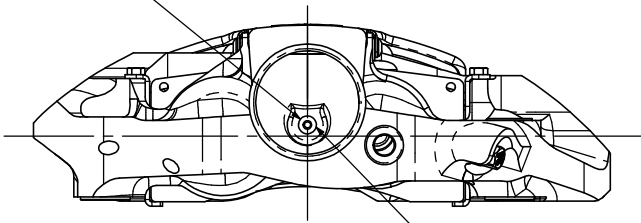

5x M4x0.70 BUTTON HEAD SCREWS  
(INCLUDED IN DUCT KIT)

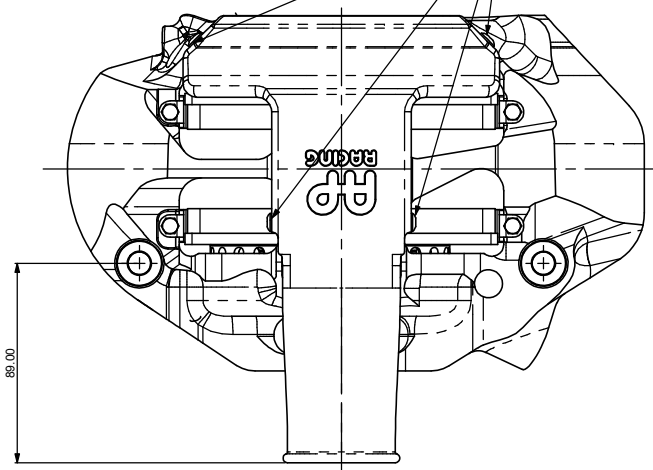
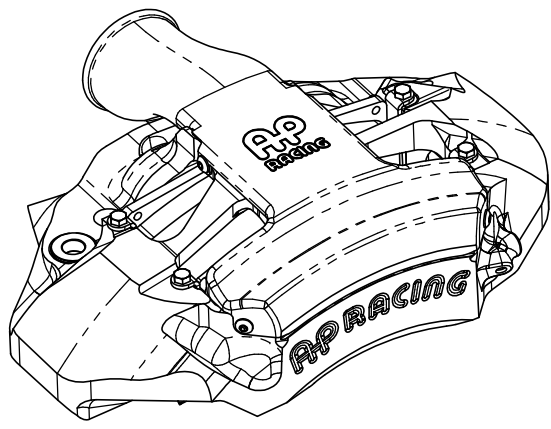

Issue No.	Alterations			Zone	Initials
	Date & No.	Particulars			

SCALE 1:1	SHEET 1 OF 3
DRAWN <i>heritage</i>	
APPROVED	
DERIVED FROM	
TITLE 4-POT S2000 RALLY CALIPER INSTALLATION DRAWING	
DRG NO.	CP6830-10CD

# B1 INSTALLATION DRAWING

IF THIS DOCUMENT IS PRINTED IN HARDCOPY, IT IS FOR INFORMATION USE ONLY AND THEREFORE IS NOT SUBJECT TO UPDATING CONTROLS. ALWAYS REFER TO SOLIDWORKS VIEWER FOR LATEST ISSUE



FIRST ANGLE PROJECTION

THIS DRAWING IS CONFIDENTIAL AND IS SUPPLIED ON THE EXPRESS CONDITION THAT IT SHALL NOT BE LOANED OR COPIED OR DISCLOSED TO ANY OTHER PERSON OR USED FOR ANY OTHER PURPOSE WITHOUT THE WRITTEN CONSENT OF AP RACING LTD.



AP Racing  
Wheler Road  
Coventry  
CV3 4LB  
Tel: +44 024 7663 9595  
Fax: +44 024 7663 9559  
e-mail: sales@apracing.co.uk  
Web site: HTTP://www.apracing.com

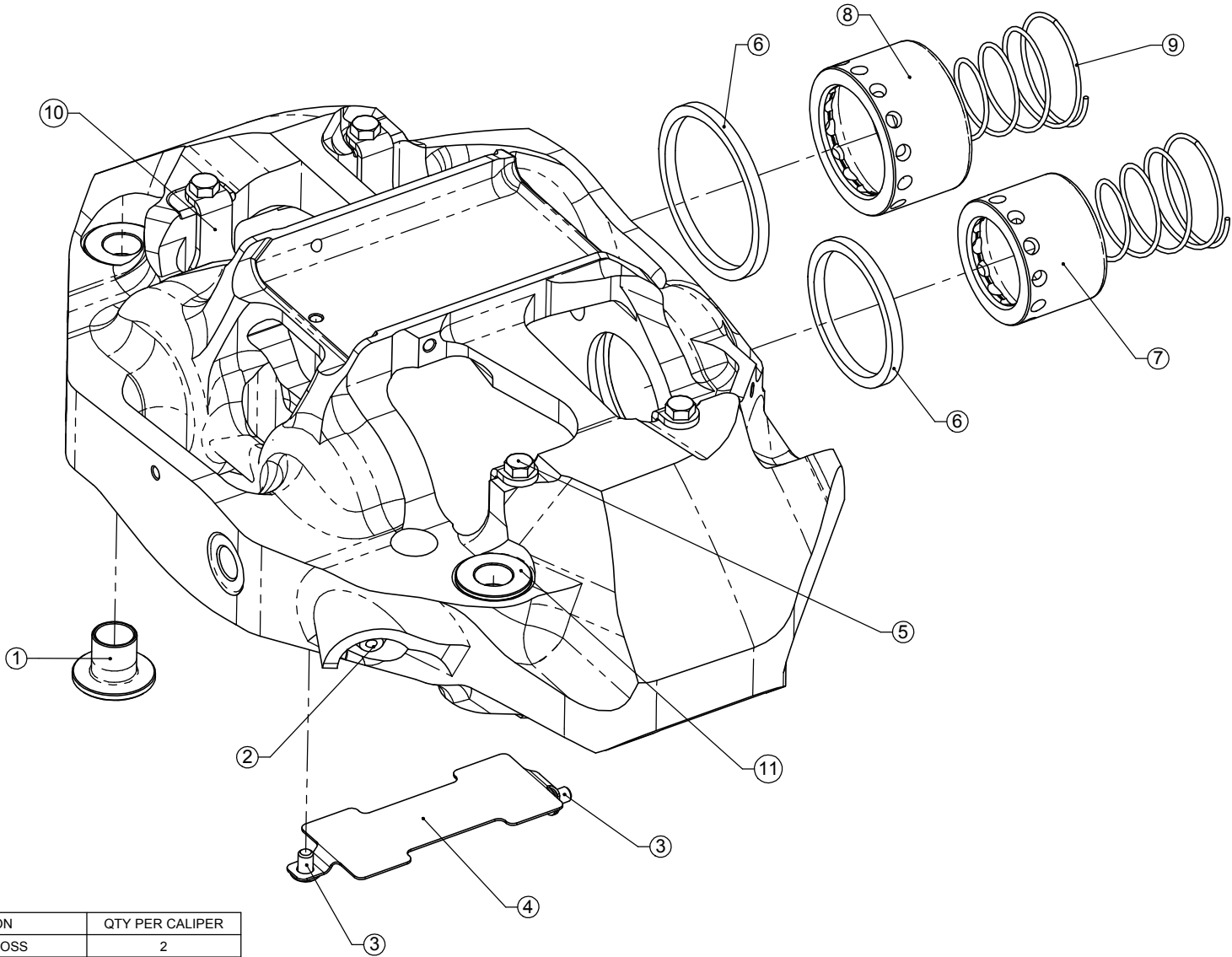

REF	PART NO.	DESCRIPTION	QTY PER CALIPER
1	CP6820-112	LOWER MTG BOSS	2
2	CP3880-1	M10 BLEED SCREW KIT	1
3	CP3355-114	M4x0.7 BUTTON HEAD SCREW	2
4	CP6820-109	PAD RETAINER WEARPLATE	1
5	CP4028-114	M4x0.7 HEX HEAD BOLT	4
6	CP4518-GK	HIGH TEMP SEAL KIT	1
7	CP6820-106	1 3/8" SST PISTON	2
8	CP6820-107	1 5/8" SST PISTON	2
9	CP2667-105	4Lb AKB SPRING	4
10	CP6830-102	PAD ABUTMENT WEARPLATE	4
11	CP6720-162	UPPER MTG BOSS	2

Issue No	Alterations			Zone	Initials
	Date & No.	Particulars			

SCALE 1:1	SHEET 1 OF 3
DRAWN <i> heritage</i>	
APPROVED	
DERIVED FROM	
TITLE	
4-POT S2000 RALLY CALIPER INSTALLATION DRAWING	
DRG NO.	CP6830-10CD

# B1 INSTALLATION DRAWING

IF THIS DOCUMENT IS PRINTED IN HARDCOPY, IT IS FOR INFORMATION USE ONLY AND THEREFORE IS NOT SUBJECT TO UPDATING CONTROLS. ALWAYS REFER TO SOLIDWORKS VIEWER FOR LATEST ISSUE



THIS DRAWING IS CONFIDENTIAL AND IS SUPPLIED ON THE EXPRESS CONDITION THAT IT SHALL NOT BE LOANED OR COPIED OR DISCLOSED TO ANY OTHER PERSON OR USED FOR ANY OTHER PURPOSE WITHOUT THE WRITTEN CONSENT OF AP RACING LTD.



**AP Racing**  
 Wheler Road  
 Coventry  
 CV3 4LB  
 Tel: +44 024 7663 9595  
 Fax: +44 024 7663 9559  
 e-mail: sales@apracing.co.uk  
 Web site: HTTP://www.apracing.com

© AP Racing Ltd. 2005

REV	Alterations			Zone	Initials
	Date & No.	Particulars	#		
1	17/07/10 B5692	FIRST ISSUE			JH

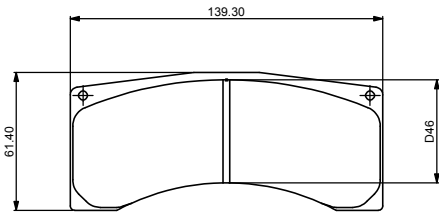
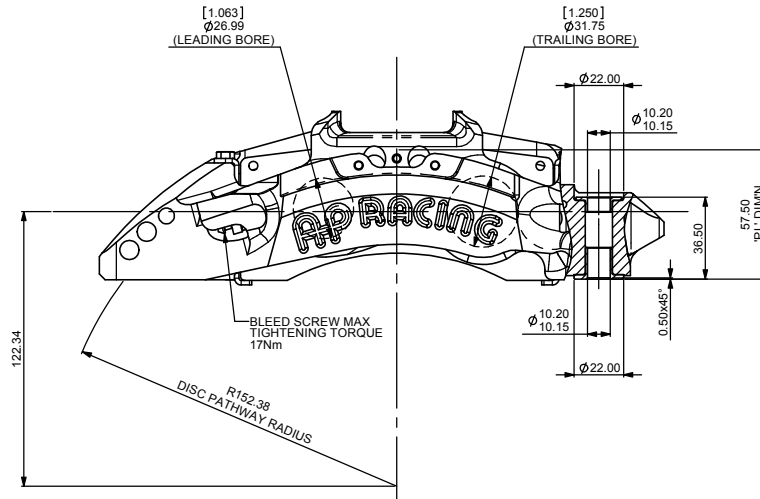
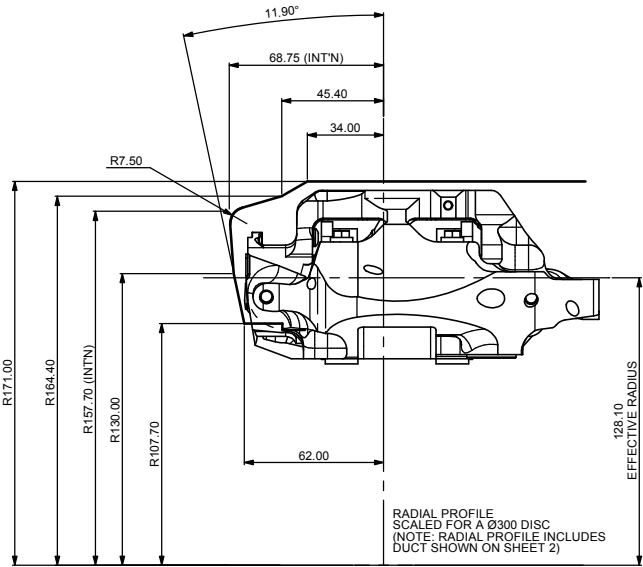

CP6821D46 FAMILY IRON PAD  
 AREA - 61.70M<sup>2</sup>  
 THICKNESS - 1.6CM  
 VOLUME - 61.7CM<sup>3</sup>

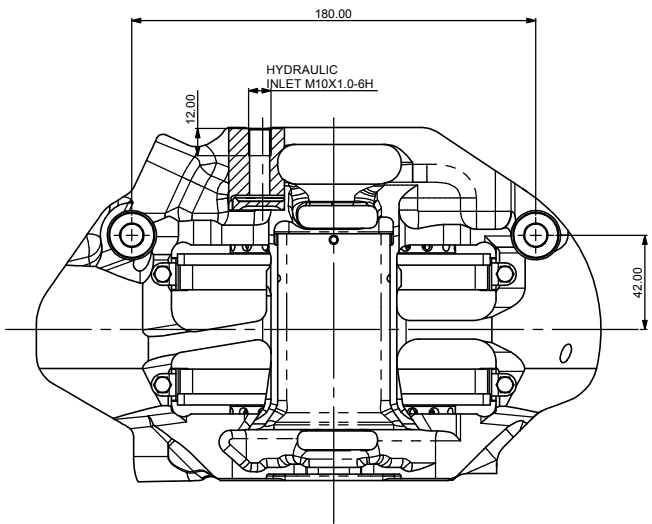

**GENERAL DESCRIPTION:**  
 4 PISTON DIFFERENTIAL BORE CALIPER TO SUIT UP TO Ø300 x 32 IRON DISC

**APPLICATION:**  
 S2000 RALLY - REAR

**TECHNICAL INFORMATION:**  
 TOTAL PISTON AREA: 27.3cm<sup>2</sup>  
 PISTON MATERIAL: STAINLESS STEEL  
 BODY MATERIAL: ALUMINIUM ALLOY  
 APPROXIMATE ASSEMBLY WEIGHT: 1.68Kg

**INSTALLATION INFORMATION**  
 DISC & CALIPER MOUNTING TOLERANCES TO BE SUCH THAT THE DISC IS CENTRAL TO THE CALIPER TO WITHIN ±0.5mm.  
 CALIPER TO BE MOUNTED WITHIN ±15° FROM VERTICAL.  
 DISC DIAMETRAL CLEARANCE SHOULD BE 2.5mm NOM. FROM DISC O.D. TO PATHWAY.  
 BLEED SCREW MAX. TIGHTENING TORQUE 17Nm

**KEY TO DIMENSIONS:**  
 'PL': TOP OF PAD MATERIAL TO MOUNTING BOSS FACE WITH PAD SITTING DOWN ON LEDGE.

**CALIPER PART NUMBERS**  
 CP6831-4S4LP - RIGHT HAND LEADING (IN FRONT OF AXLE)  
 CP6831-4S4LP - LEFT HAND LEADING (IN FRONT OF AXLE)

SCALE 1:1	SHEET 1 OF 3
DRAWN heritage	
APPROVED	
DERIVED FROM	
TITLE	
4-POT S2000 RALLY CALIPER INSTALLATION DRAWING	
DRG NO.	CP6831-10CD

B1 INSTALLATION DRAWING

IF THIS DOCUMENT IS PRINTED IN HARDCOPY, IT IS FOR INFORMATION USE ONLY AND THEREFORE IS NOT SUBJECT TO UPDATING CONTROLS. ALWAYS REFER TO SOLIDWORKS VIEWER FOR LATEST ISSUE.

FIRST ANGLE PROJECTION

THIS DRAWING IS CONFIDENTIAL AND IS SUPPLIED ON THE EXPRESS CONDITION THAT IT SHALL NOT BE LOANED OR COPIED OR DISCLOSED TO ANY OTHER PERSON OR USED FOR ANY OTHER PURPOSE WITHOUT THE WRITTEN CONSENT OF AP RACING LTD.



© AP Racing Ltd. 2005

AP Racing  
Wheler Road  
Coventry  
CV3 4LB

Tel: +44 (0)24 7663 9595  
Fax: +44 (0)24 7663 9599  
e-mail: sales@apracings.co.uk  
Web site: HTTP://www.apracings.com

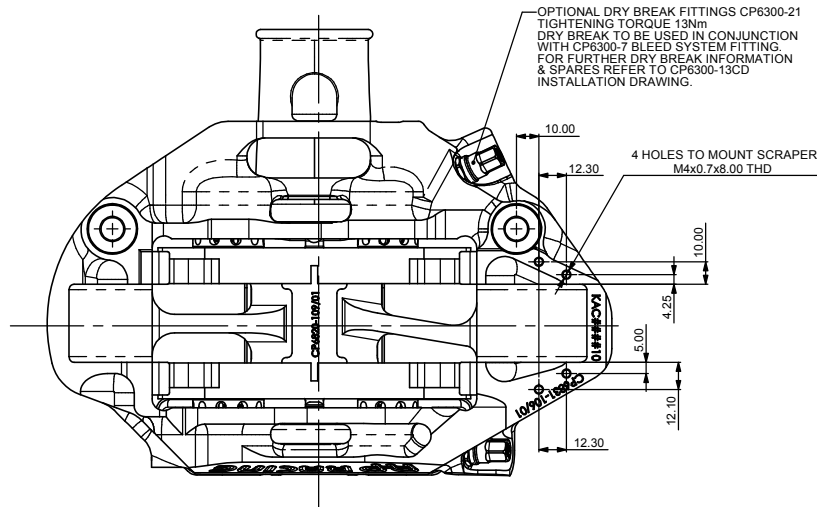
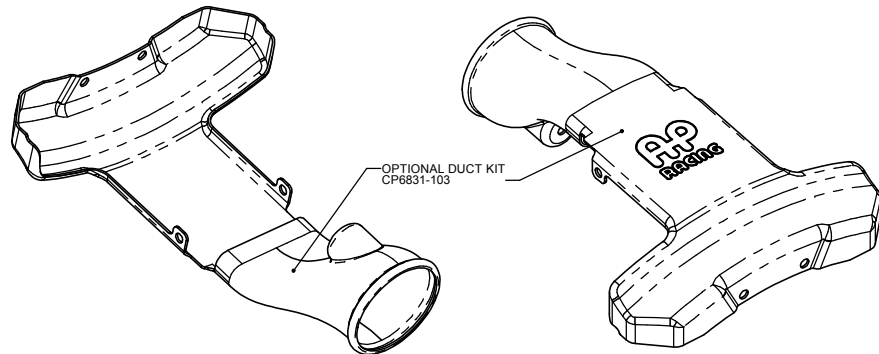

THE RECESS IN THE DUCT CAN BE COVERED WITH DUCK TAPE OR SIMILAR ONCE THE SCREW HAS BEEN FITTED TO CREATE A SMOOTH SURFACE FOR THE AIR FLOW

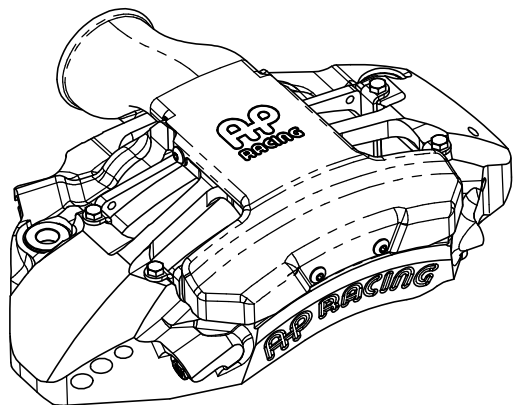
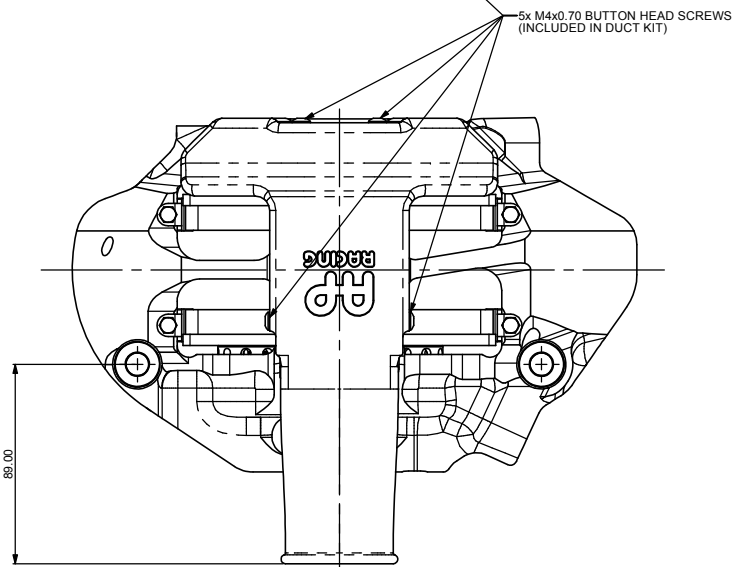
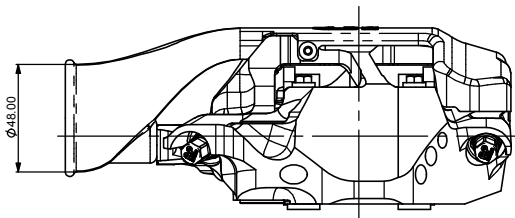
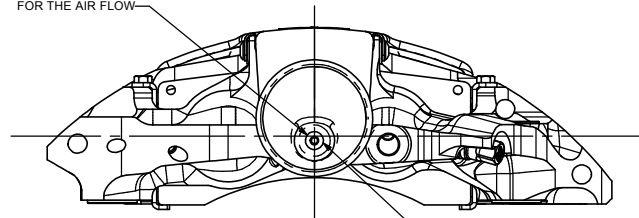

Rev No.	Alterations		Zone	Initials
	Date & No.	Particulars		

SCALE 1:1 SHEET 1 OF 3

DRAWN *heritage*

APPROVED

DERIVED FROM

TITLE  
4-POT S2000 RALLY CALIPER  
INSTALLATION DRAWING

DRG NO. CP6831-10CD

**B1** **INSTALLATION**  
**DRAWING**

IF THIS DOCUMENT IS PRINTED IN HARDCOPY,  
IT IS FOR INFORMATION USE ONLY AND THEREFORE  
IS NOT SUBJECT TO UPDATING CONTROLS. ALWAYS  
REFER TO SOLIDWORKS VIEWER FOR LATEST ISSUE

 **FIRST ANGLE**  
**PROJECTION**

THIS DRAWING IS CONFIDENTIAL AND IS SUPPLIED ON THE EXPRESS CONDITION THAT  
IT SHALL NOT BE LOANED OR COPIED OR DISCLOSED TO ANY OTHER PERSON OR USED  
FOR ANY OTHER PURPOSE WITHOUT THE WRITTEN CONSENT OF AP RACING LTD.

**AP RACING**  
AP Racing  
Wheler Road  
Coventry  
CV3 4LB  
Tel: +44 024 7663 9595  
Fax: +44 024 7663 9559  
e-mail: sales@aprac racing.co.uk  
Web site: HTTP://www.aprac racing.com  
© AP Racing Ltd. 2005

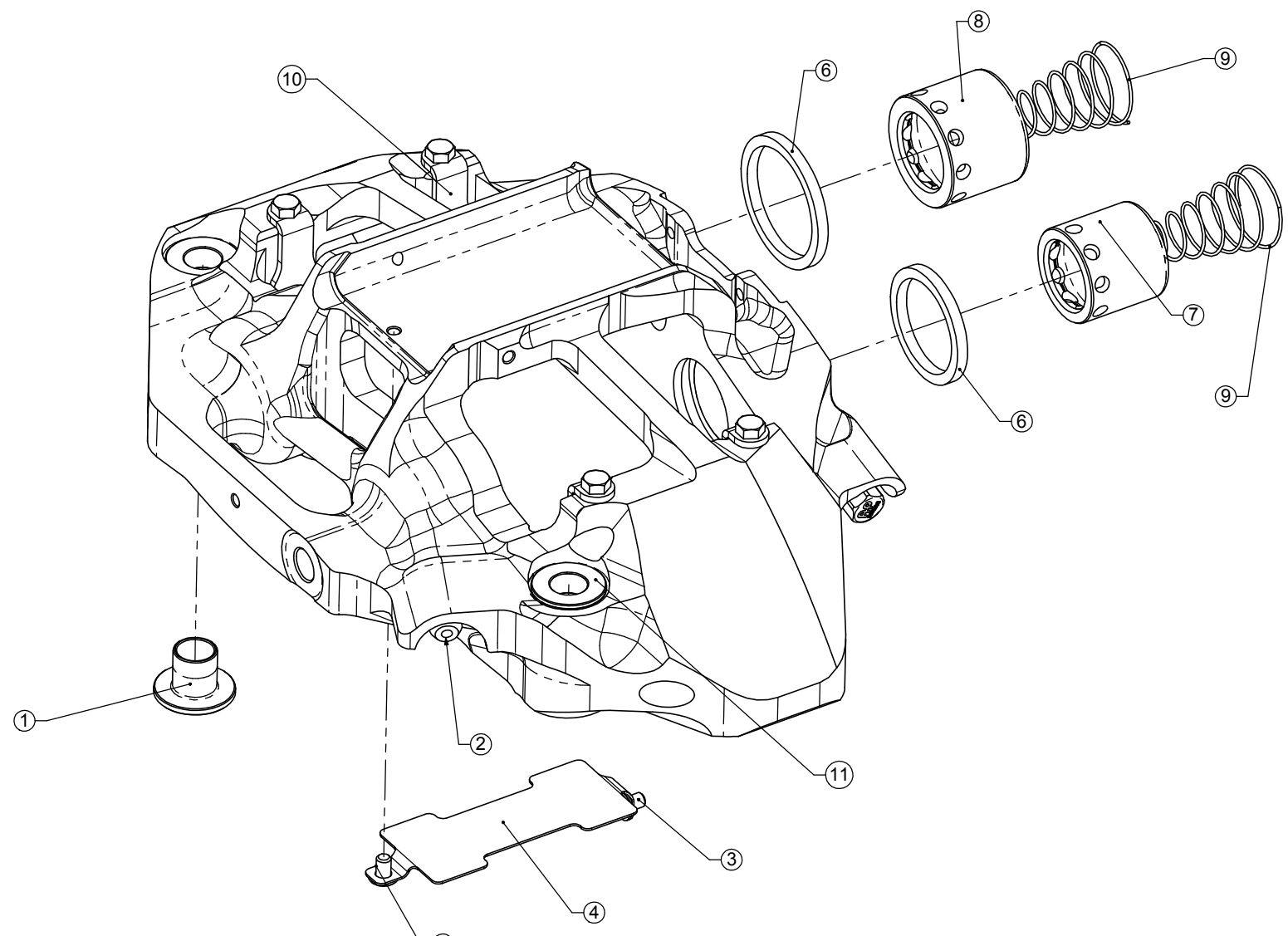

REF	PART NO.	DESCRIPTION	QTY PER CALIPER
1	CP6830-103	LOWER MTG BOSS	2
2	CP3880-1	M10 BLEED SCREW KIT	1
3	CP3355-114	M4x0.7 BUTTON HEAD SCREW	2
4	CP6820-109	PAD RETAINER WEARPLATE	1
5	CP4028-114	M4x0.7 HEX HEAD BOLT	4
6	CP4518-CE	HIGH TEMP SEAL KIT	1
7	CP6821-105	1 1/16" SST PISTON	2
8	CP6821-104	1 1/4" SST PISTON	2
9	CP2632-113	4lb AKB SPRING	4
10	CP6820-113	PAD ABUTMENT WEARPLATE	4
11	CP6720-162	UPPER MTG BOSS	2

Issue No.	Alterations		Zone	Initials
	Date & No.	Particulars		

SCALE 1:1 SHEET 1 OF 3

DRAWN /heritage

APPROVED

DERIVED FROM

TITLE  
**4-POT S2000 RALLY CALIPER**  
**INSTALLATION DRAWING**

DRG NO. CP6831-10CD