

B1 INSTALLATION DRAWING

IF THIS DOCUMENT IS PRINTED IN HARDCOPY, IT IS FOR INFORMATION USE ONLY AND THEREFORE IS NOT SUBJECT TO UPDATING CONTROLS. ALWAYS REFER TO SOLIDWORKS VIEWER FOR LATEST ISSUE



THIS DRAWING IS CONFIDENTIAL AND IS SUPPLIED ON THE EXPRESS CONDITION THAT IT SHALL NOT BE LOANED OR COPIED OR DISCLOSED TO ANY OTHER PERSON OR FOR ANY OTHER PURPOSE WITHOUT THE WRITTEN CONSENT OF AP RACING LTD.

AP RACING
 AP Racing Ltd. 2005
 AP Racing
 Wheler Road
 Coventry
 CV3 4LB
 Tel: +44 024 7663 9595
 Fax: +44 024 7663 9559
 e-mail: sales@apracings.co.uk
 Web site: HTTP://www.apracings.com

GENERAL DESCRIPTION
4 PISTON DIFFERENTIAL BORE CALIPER TO SUIT UP TO Ø355 x 32 CARBON DISC & UP TO Ø355 x32.0 IRON DISC

APPLICATION
GT REAR

TECHNICAL INFORMATION
TOTAL PISTON AREA: 33.2cm²
PISTON MATERIAL: TITANIUM or STAINLESS STEEL
BODY MATERIAL: ALUMINIUM ALLOY

ASSEMBLY WEIGHT:-
• TITANIUM PISTONS - 2.1Kg
• STAINLESS STEEL PISTONS - 2.22Kg

INSTALLATION INFORMATION
DISC & CALIPER MOUNTING TOLERANCES TO BE SUCH THAT THE DISC IS CENTRAL TO THE CALIPER TO WITHIN +0.5mm. DISC DIAMETRAL CLEARANCE SHOULD BE 2.5mm NOMINAL FROM DISC O/D TO PATHWAY.

KEY TO DIMENSIONS
'PL' DIMM - TOP OF PAD MATERIAL TO MOUNTING BOSS FACE, WITH PAD SITTING DOWN ON LEDGE.
'U' DIMM - WHEEL CENTRE LINE TO CALIPER MOUNTING BOSS FACE = (DISC Ø/2) - PL DIMM

CALIPER PART NUMBERS :

CP6470-2S7MP - RIGHT HAND TITANIUM PISTONS
CP6470-3S7MP - LEFT HAND TITANIUM PISTONS

CP6470-2S7LP - RIGHT HAND STAINLESS STEEL PISTONS
CP6470-3S7LP - LEFT HAND STAINLESS STEEL PISTONS

PART No. WITH 'M' DENOTE TITANIUM PISTONS
PART No. WITH 'L' DENOTE STAINLESS STEEL PISTONS

CP6470-2S7MPD - RIGHT HAND
CP6470-3S7MPD - LEFT HAND
(D' SUFFIX CALIPER ASSEMBLIES INCLUDE COOLING DUCT & DRY-BREAK FITTING)

CP6470-2S7MC - RIGHT HAND
CP6470-3S7MC - LEFT HAND
(C' SUFFIX CALIPER ASSEMBLIES INCLUDE 1.5MM THICK CERAMIC PISTON CAPS)

CP6470-2S7MCD - RIGHT HAND
CP6470-3S7MCD - LEFT HAND
(CD' SUFFIX CALIPER ASSEMBLIES INCLUDE 1.5MM THICK CERAMIC PISTON CAPS, COOLING DUCT & DRY-BREAK FITTING)

NOTE: 'D' SUFFIX CALIPERS ARE BUILT TO SUIT A LEADING (IN FRONT OF AXLE) APPLICATION BUT THEY CAN BE USED IN A TRAILING (BEHIND AXLE) POSITION BY SWAPPING THE DRY-BREAK FITTING & BLEED SCREW OVER.

Issue No	Alterations			Zone	Initials
	Date & No.	Particulars	#		
1	10/05/10 B5600	FIRST ISSUE			JH
2	15/05/14 B7102	STAINLESS STEEL PISTON OPTION ADDED		15K	SAT

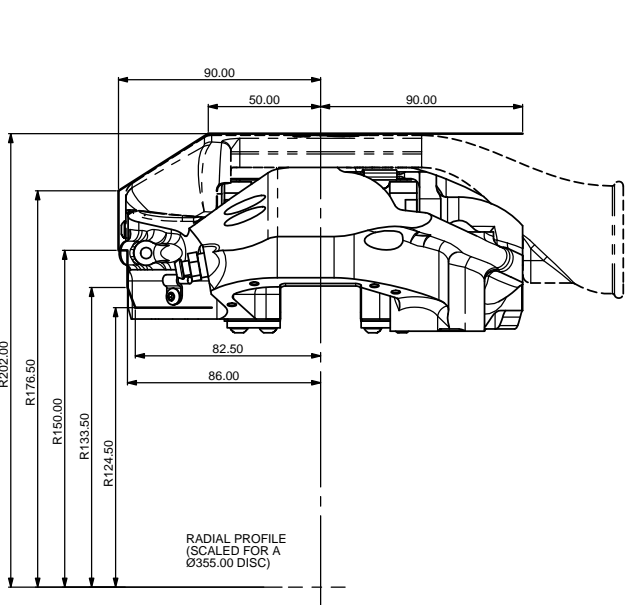

THINNER PAD LEDGES ARE AVAILABLE IF THIS IS A PROBLEM.

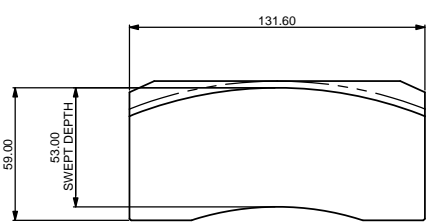
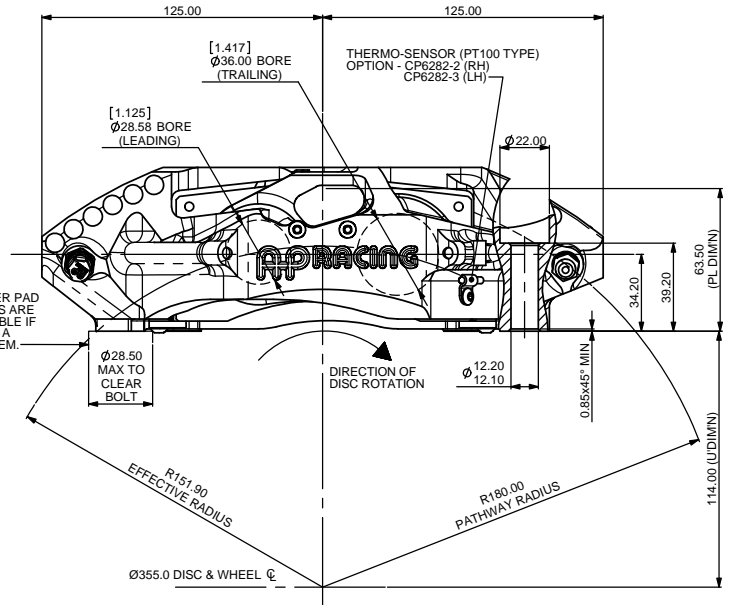

CP6070-108H## CARBON/CARBON PAD
AREA: 69.1cm²
THICKNESS: 25mm

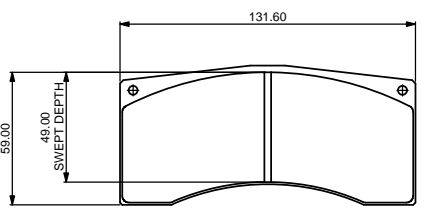

CP6070D49 FAMILY IRON PAD
AREA: 61.6cm²
THICKNESS: 25mm

TYPICAL MTG TIGHTENING TORQUE, FOR GUIDANCE ONLY: M12 - 65Nm & M10 - 54Nm

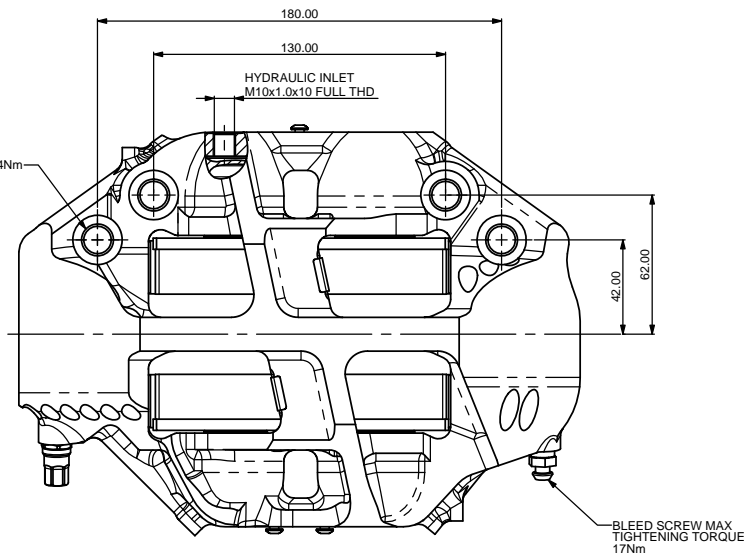

SCALE 1:1	SHEET 1 OF 3
DRAWN Heritage	
APPROVED	
DERIVED FROM	
TITLE 4-POT REAR GT CALIPER	
DRG NO.	CP6470-1CD

