

# B1 INSTALLATION DRAWING

IF THIS DOCUMENT IS PRINTED IN HARD COPY, IT IS FOR INFORMATION USE ONLY AND THEREFORE IS NOT SUBJECT TO UPDATING CONTROLS. ALWAYS REFER TO SOLIDWORKS VIEWER FOR LATEST ISSUE



THIS DRAWING IS CONFIDENTIAL AND IS SUPPLIED ON THE EXPRESS CONDITION THAT IT SHALL NOT BE LOANED OR COPIED OR DISCLOSED TO ANY OTHER PERSON OR USED FOR ANY OTHER PURPOSE WITHOUT THE WRITTEN CONSENT OF AP RACING LTD.

**AP Racing**  
Wheler Road  
Coventry  
CV3 4LB  
Tel: +44 024 7663 9595  
Fax: +44 024 7663 9559  
e-mail: sales@apracing.co.uk  
Web site: HTTP://www.apracing.com

© AP Racing Ltd. 2005

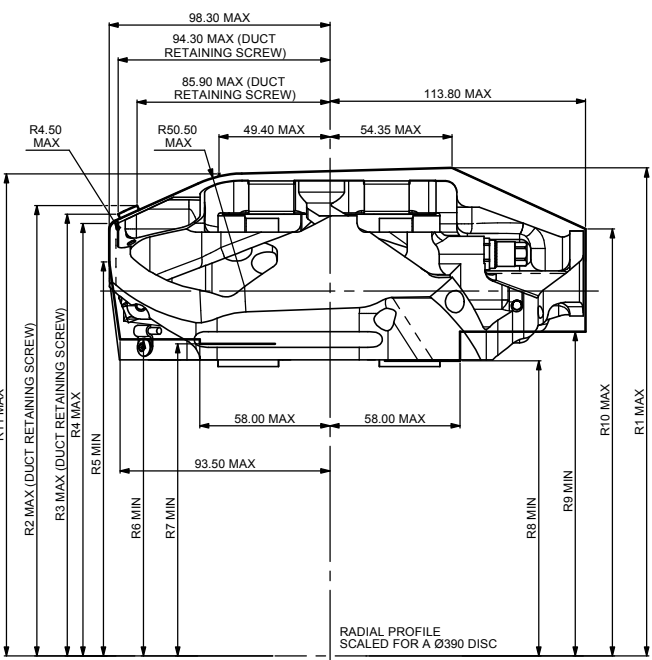

RADIAL PROFILE SCALED FOR A Ø390 DISC

RADIAL PROFILE DATA

DISC	R1	R2	R3	R4	R5	R6	R7	R8	R9	R10	R11	EFF RAD
Ø390	217.40	200.7	196.8	192.7	175.5	141	139.1	131.5	144.5	190.3	214.7	168.4
Ø380	212.40	195.7	191.8	187.7	170.5	136.3	135	128.5	139.5	185.3	209.7	163.4

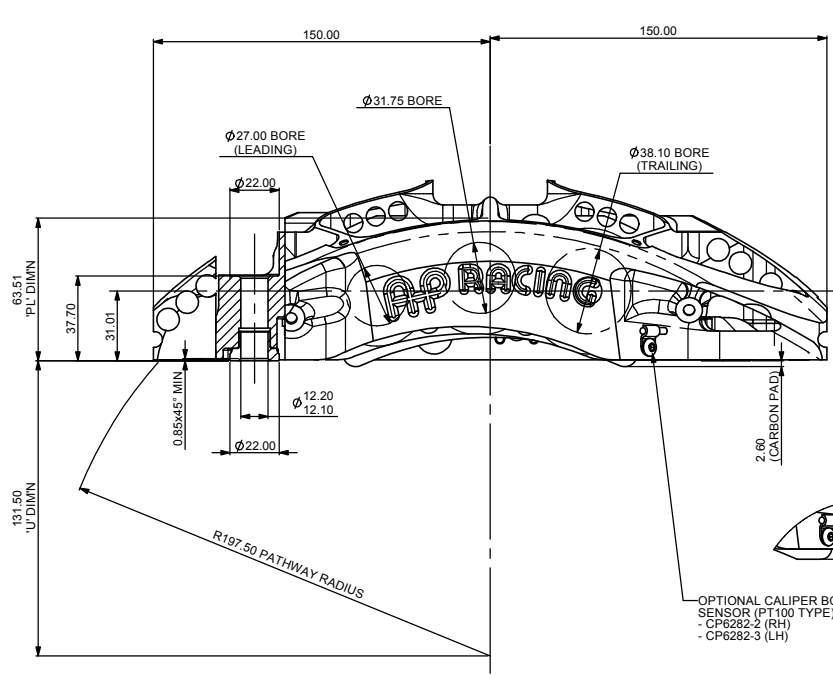

**GENERAL DESCRIPTION**  
THIS IS A 6 PISTON DIFFERENTIAL BORE CALIPER TO SUIT UP TO Ø390x35.6 IRON DISC & Ø380 x 37 CARBON DISC.

**APPLICATION**  
FIA - LMP 1 / LMP 2 / GT1 / SUPER GT (JAPAN)

**TECHNICAL INFORMATION**  
TOTAL PISTON AREA: 90.1cm<sup>2</sup>  
PISTON MATERIAL: TITANIUM  
BODY MATERIAL: ALUMINIUM ALLOY  
MOUNTING BOSS MATERIAL: STAINLESS STEEL  
ASSEMBLY WEIGHT (LESS PADS): 2.5Kg

**INSTALLATION INFORMATION**  
DISC & CALIPER MOUNTING TOLERANCES TO BE SUCH THAT THE DISC IS CENTRAL TO THE CALIPER TO WITHIN ±0.5mm.  
CALIPER TO BE MOUNTED WITHIN ±15° FROM VERTICAL.  
DISC DIAMETRAL CLEARANCE SHOULD BE 2.5mm NOM. FROM DISC OD TO PATHWAY.  
BLEED SCREW MAX TIGHTENING TORQUE 17Nm  
MAX NEW DISC & PAD STACK = 95.6MM  
**MINIMUM WORN DISC & PAD STACK = 49MM**

**KEY DIMENSIONS**  
P1 TOP OF PAD MATERIAL TO MOUNTING BOSS FACE WITH PAD SITTING DOWN ON LEDGE.  
U WHEEL CENTRE LINE TO CALIPER MOUNTING BOSS FACE (DISC Ø2)-DIMENSION P1.  
EFFECTIVE RADIUS: DISTANCE FROM WHEEL CENTRE LINE TO NOMINAL PISTON CENTRE LINE.

AP RACING TECHNICAL SECTION WILL BE PLEASED TO ADVISE ON THE MOST SUITABLE EQUIPMENT FOR ANY PARTICULAR APPLICATION.

**CALIPER PART NUMBERS**  
CP6160-2S7MP - RIGHT HAND TRAILING (BEHIND AXLE)  
CP6160-3S7MP - LEFT HAND TRAILING (BEHIND AXLE)  
CP6160-2S7MPD - RIGHT HAND TRAILING (BEHIND AXLE) INC. DUCT  
CP6160-3S7MPD - LEFT HAND TRAILING (BEHIND AXLE) INC. DUCT

**NOTE: CALIPERS CAN BE USED IN A LEADING (IN FRONT OF AXLE) POSITION BY SWAPPING THE INLET ADAPTOR AND BLEED SCREW OVER.**

P1 SUFFIX DENOTES CALIPER WITH 'CLIP-IN' TYPE PISTONS. FOR ADDITION OF 'CLIP-IN' PISTON CAPS SEE CP6060-1PCD DRAWING.

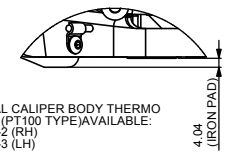

OPTIONAL CALIPER BODY THERMO SENSOR (PT100 TYPE) AVAILABLE:  
- CP6282-2 (RH)  
- CP6282-3 (LH)

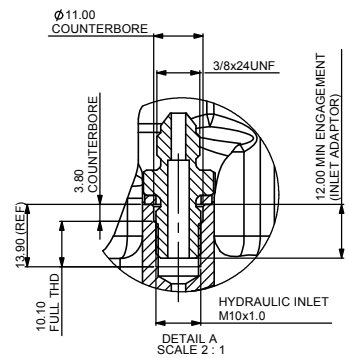
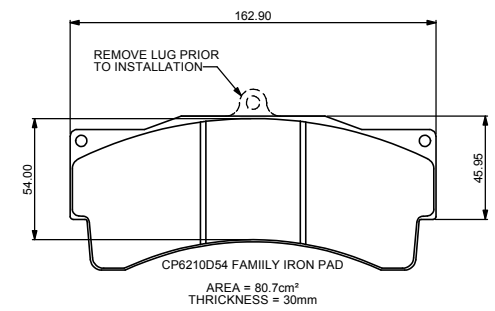

TYPICAL MTG TIGHTENING TORQUE FOR GUIDANCE ONLY:  
M12 - 65Nm & M10 - 54Nm

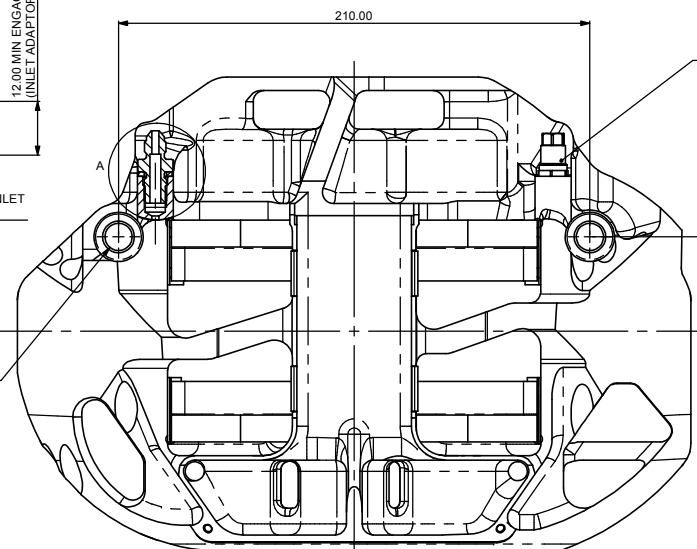

DRY BREAK FITTING TIGHTENING TORQUE 13Nm  
DRY BREAK TO BE USED IN CONJUNCTION WITH CP6300-7 BLEED SYSTEM FITTING. FOR FURTHER DRY BREAK INFORMATION & SPARES REFER TO CP6300-13CD INSTALLATION DRAWING.

NOTE: DRY BREAK AND INLET ADAPTOR MUST BE SWAPPED OVER IF THE CALIPER IS BEING USED IN A LEADING (IN FRONT OF THE AXLE) POSITION.

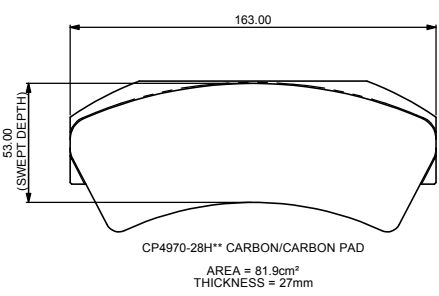
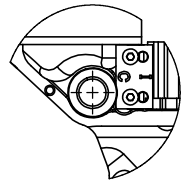

WHEN RUNNING CP6210 IRON PADS THE PAD SUPPORTS MUST BE TURNED AROUND. THE LETTERS 'I' ON THE PAD SUPPORTS MUST FACE EACH OTHER AS SHOWN. AP RACING RECOMMEND THE USE OF A THREADLOCKER (LOCTITE 243 OR SIMILAR) ON THE PAD SUPPORT RETAINING SCREWS.

CARBON SET-UP = LETTERS 'C' FACE EACH OTHER  
IRON SET-UP = LETTERS 'I' FACE EACH OTHER

Rev	Alterations			Zone	Initials
	Date & No.	Particulars	#		
1	28/01/08 B4960	FIRST ISSUE		JH	
2	05/02/08 B4960:12	INLET ADAPTOR ADDED. LEADING PART NUMBERS REMOVED. MIN WORN STACK NOTE ADDED		JH	
3	21/02/08 B4960	BLEED SCREW REPLACED WITH DRY BREAK FITTING		JH	
4	26/02/08 B4960	RADIAL PROFILE UPDATED		JH	
5	17/04/08 B4960:19	CALIPER WITH DUCT PART NUMBERS ADDED		JH	
6	05/02/09 B4960	CP4970-28 WAS CP4970-30. 95.6 CARBON STACK ADDED	B3 M15	JH	
7	15/07/09 B4960	PAD SUPPORT ITEM 2 WAS CP4970-141. ALTERNATIVE PAD SUPPORT -105 ADDED. [SHT 3]		RLB	

SCALE 1:1 SHEET 1 OF 3

DRAWN *heritage*

APPROVED

DERIVED FROM

TITLE  
**6-POT GT RADI-CAL**

DRG NO. CP6160-1CD

**B1** INSTALLATION DRAWING

IF THIS DOCUMENT IS PRINTED IN HARD COPY, IT IS FOR INFORMATION USE ONLY AND THEREFORE IS NOT SUBJECT TO UPDATING CONTROLS. ALWAYS REFER TO SOLIDWORKS VIEWER FOR LATEST ISSUE



THIS DRAWING IS CONFIDENTIAL AND IS SUPPLIED ON THE EXPRESS CONDITION THAT IT SHALL NOT BE LOANED OR COPIED OR DISCLOSED TO ANY OTHER PERSON OR USED FOR ANY OTHER PURPOSE WITHOUT THE WRITTEN CONSENT OF AP RACING LTD.



AP Racing  
Wheler Road  
Coventry  
CV3 4LB

Tel: +44 024 7663 9595  
Fax: +44 024 7663 9599  
e-mail: sales@apracing.co.uk  
Web site: HTTP://www.apracing.com

© AP Racing Ltd. 2005

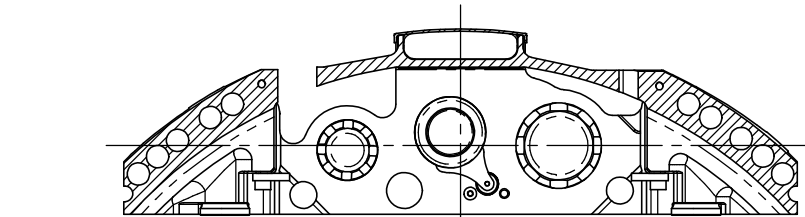

SECTION C-C

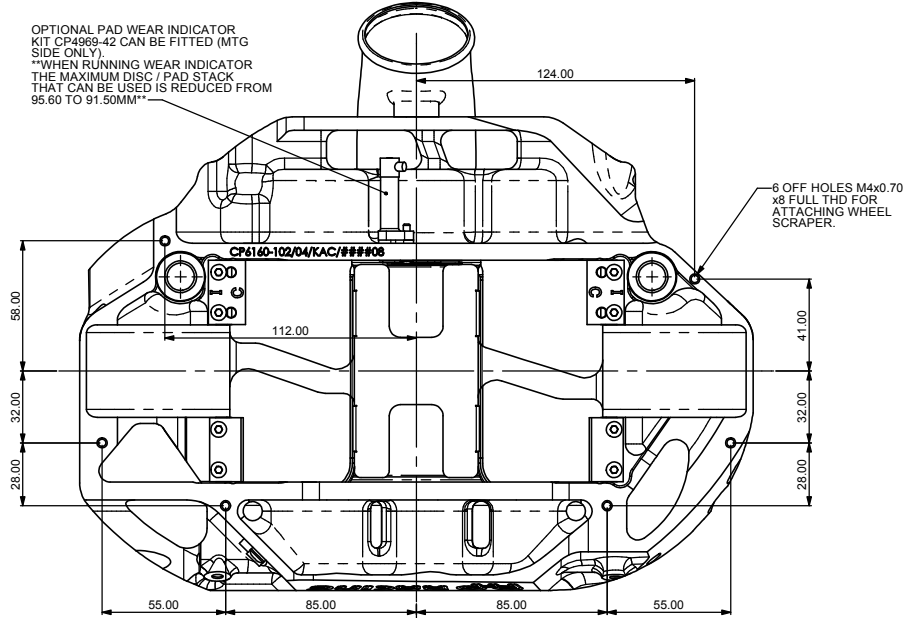
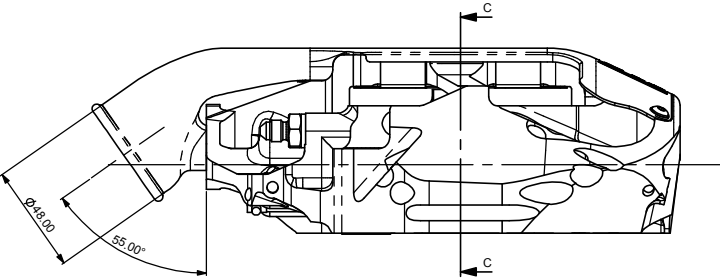

OPTIONAL PAD WEAR INDICATOR KIT CP4969-42 CAN BE FITTED (MTG SIDE ONLY).  
\*\*WHEN RUNNING WEAR INDICATOR THE MAXIMUM DISC / PAD STACK THAT CAN BE USED IS REDUCED FROM 95.60 TO 91.50MM\*\*

6 OFF HOLES M4x0.70 x8 FULL THD FOR ATTACHING WHEEL SCRAPER.

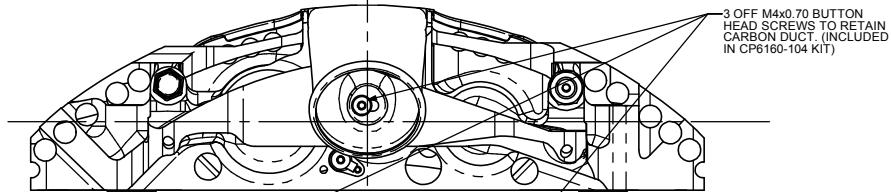

3 OFF M4x0.70 BUTTON HEAD SCREWS TO RETAIN CARBON DUCT. (INCLUDED IN CP6160-104 KIT)

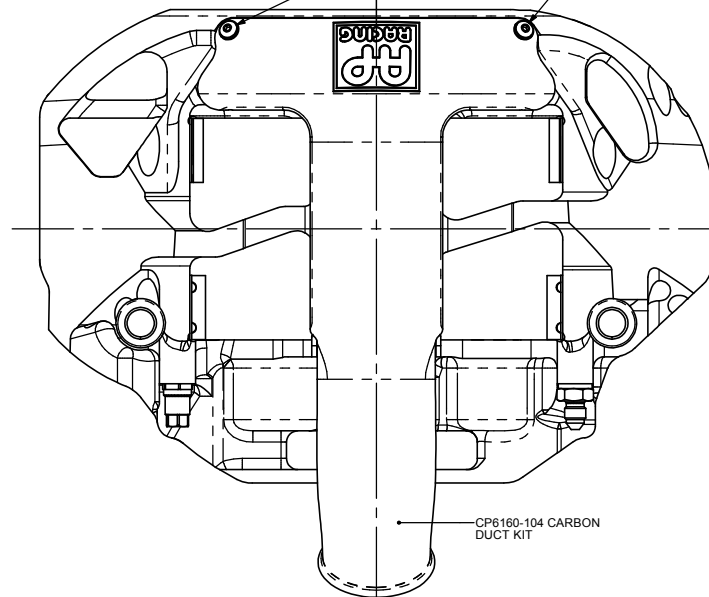
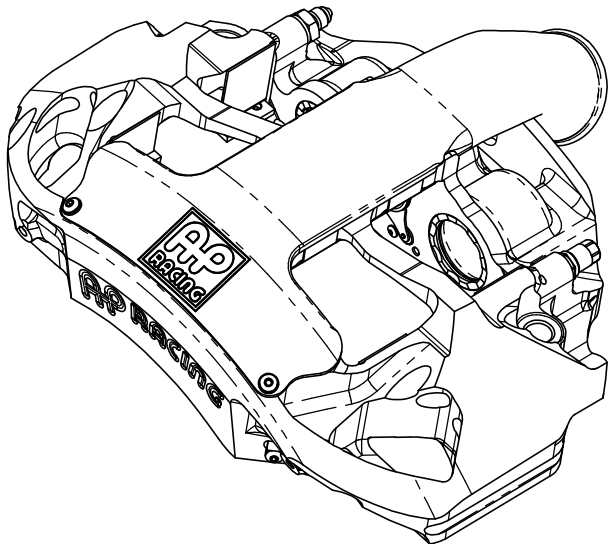

CP6160-104 CARBON DUCT KIT

Alterations		Zone	Initials
Date & No.	Particulars		
#	SEE SHEET 1 FOR ISSUE DETAILS		

SCALE 1:1	SHEET 1 OF 3
DRAWN	heritage
APPROVED	
DERIVED FROM	
TITLE 6-POT GT RADI-CAL	
DRG NO.	CP6160-1CD

# B1 INSTALLATION DRAWING

IF THIS DOCUMENT IS PRINTED IN HARD COPY, IT IS FOR INFORMATION USE ONLY AND THEREFORE IS NOT SUBJECT TO UPDATING CONTROLS. ALWAYS REFER TO SOLIDWORKS VIEWER FOR LATEST ISSUE



FIRST ANGLE PROJECTION

THIS DRAWING IS CONFIDENTIAL AND IS SUPPLIED ON THE EXPRESS CONDITION THAT IT SHALL NOT BE LOANED OR COPIED OR DISCLOSED TO ANY OTHER PERSON OR USED FOR ANY OTHER PURPOSE WITHOUT THE WRITTEN CONSENT OF AP RACING LTD.



AP Racing  
Wheler Road  
Coventry  
CV3 4LB

Tel: +44 024 7683 9595  
Fax: +44 024 7683 9559  
e-mail: sales@apracing.co.uk  
Web site: HTTP://www.apracing.com

© AP Racing Ltd. 2005

### CP6160-2/3/4/5S7MP SPARE PARTS LIST

REF	PART NO.	DESCRIPTION	QTY
1	CP3215-115	M4x0.70x12 CAP SCREW	8
2	CP4970-142	PAD SUPPORT	4
	CP4970-105	ALTERNATIVE SUPPORT FOR USE WITH IRON PAD ONLY	4
3	CP6060-107	WEARPLATE	4
4	CP6086-104	WEARPLATE	1
5	CP6056-106	MOUNTING BOSS	2
6	CP4969-15	LVDT ROD/YOKE SUB ASSY	1
7	CP4518-CEJ	SEAL KIT	1
8	CP6055-110	Ø1.06" TITANIUM PISTON	2
9	CP6055-111	Ø1.25" TITANIUM PISTON	2
10	CP6055-112	Ø1.50" TITANIUM PISTON	2
11	CP6518-7LBSSL	7LB AKB SPRING KIT	1
12	CP6086-105	Ø1.25" LVDT PISTON	1
13	CP6160-107	M10 - 3/8" INLET ADAPTOR	1
14	KL44517	GASKET	1

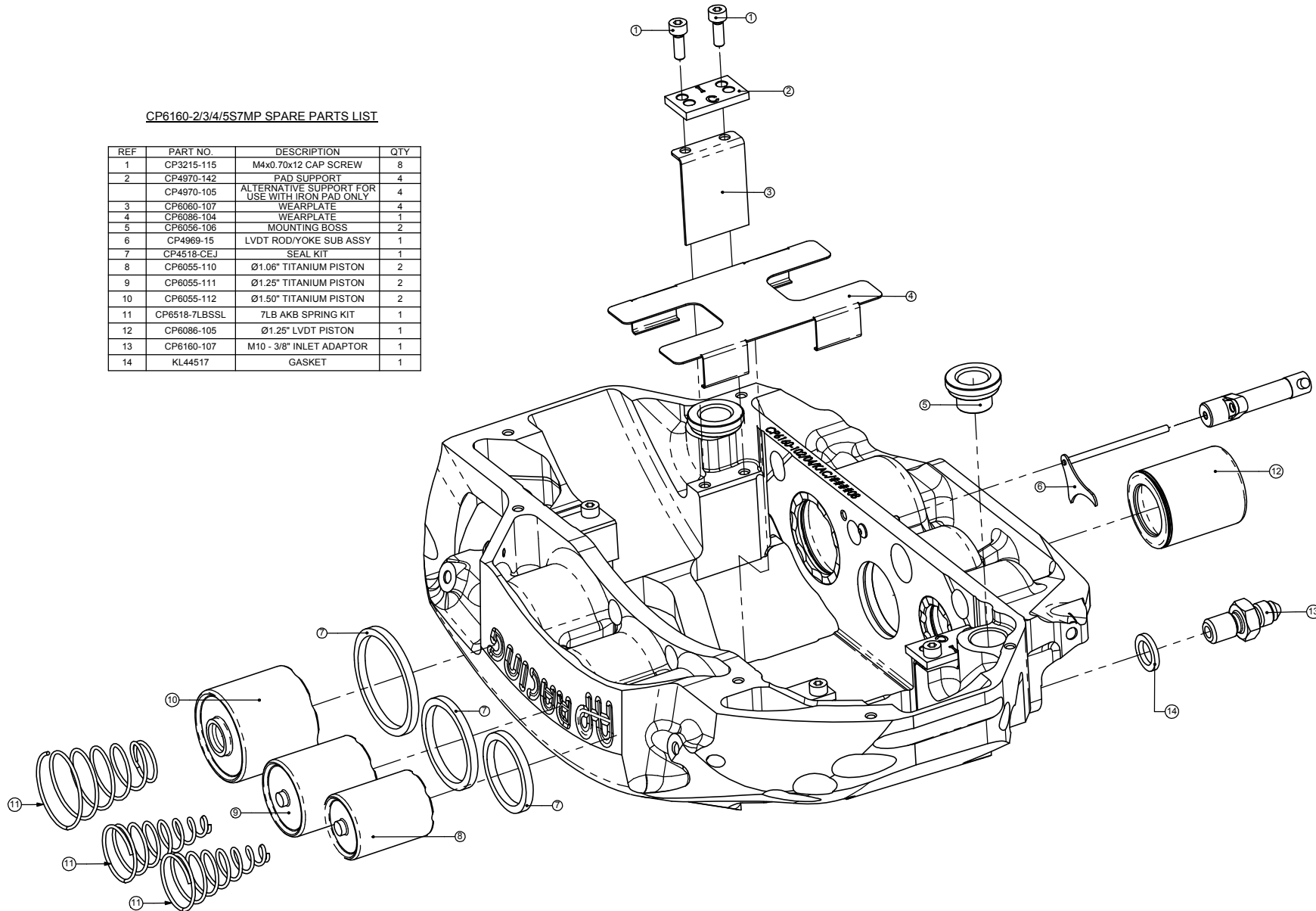

Alterations			
Date & No.	Particulars	Zone	Initials
#	SEE SHEET 1 FOR ISSUE DETAILS	#	#

SCALE 1:1	SHEET 1 OF 3
DRAWN heritage	
APPROVED	
DERIVED FROM	
TITLE 6 POT GT RADICAL	
DRG NO.	CP6160-1CD