

# A0 INSTALLATION DRAWING

IF THIS DOCUMENT IS PRINTED IN HARD COPY, IT IS FOR INFORMATION USE ONLY AND THEREFORE IS NOT SUBJECT TO UPDATING CONTROLS. ALWAYS REFER TO SOLIDWORKS VIEWER FOR LATEST ISSUE

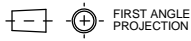

THIS DRAWING IS CONFIDENTIAL AND IS SUPPLIED ON THE EXPRESS CONDITION THAT IT SHALL NOT BE LOANED OR COPIED OR DISCLOSED TO ANY OTHER PERSON OR USED FOR ANY OTHER PURPOSE WITHOUT THE WRITTEN CONSENT OF AP RACING LTD.

**AP Racing**  
Wheler Road  
Coventry  
CV3 4LB  
Tel: +44 (0)24 7663 9595  
Fax: +44 (0)24 7663 9559  
e-mail: sales@apracings.co.uk  
Web site: HTTP://www.apracings.com

© AP Racing Ltd. 2005

**GENERAL DESCRIPTION**  
THIS A GENERAL PURPOSE FLOOR MOUNTED PEDAL BOX WITH FORWARD FACING PUSH TYPE MASTER CYLINDERS.

- FEATURES**
- LIGHTWEIGHT ALUMINIUM BILLET BASE
  - DESIGNED FOR USE WITH CP7854 TYPE MASTER CYLINDERS SEE CP7854-10CD FOR MASTER CYLINDER DETAILS
  - ADJUSTABLE FOOT PADS FOR OPTIMUM DRIVER COMFORT
  - ADJUSTABLE CLUTCH STOP
  - 4.8:1 BRAKE AND CLUTCH PEDAL RATIO
  - BALL BEARINGS BRAKE & CLUTCH PIVOTS TO REDUCE LOSSES & GIVE SMOOTH OPERATION
  - PEDAL BOX WEIGHT, WITHOUT MASTER CYLINDERS, 1.75 Kg.

**PART NUMBER**  
CP5509-1 - BRAKE AND CLUTCH PEDAL BOX (EXCLUDING MASTER CYLINDERS)

**NOTE:-**  
A TRAVEL SENSOR KIT TO SUIT THE MASTER CYLINDERS USED WITH THIS PEDAL BOX IS AVAILABLE UNDER THE PART No. CP5854-10.  
THE TRAVEL SENSOR MOUNTS ONTO THE CYLINDER. FOR INSTALLATION DATA SEE DRAWING CP5854-10CD.

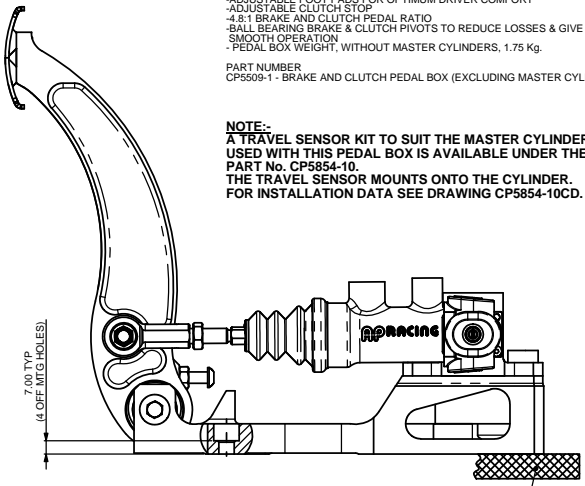

7.00 TYP.  
(4 OFF MTG HOLES)

IN ADDITION TO SUPPORTING THE PEDAL BOX UNDERNEATH THE FOUR MOUNTING HOLES, THE PEDAL BOX MUST BE FULLY SUPPORTED UNDERNEATH THE BALANCE BAR HOUSING AS SHOWN

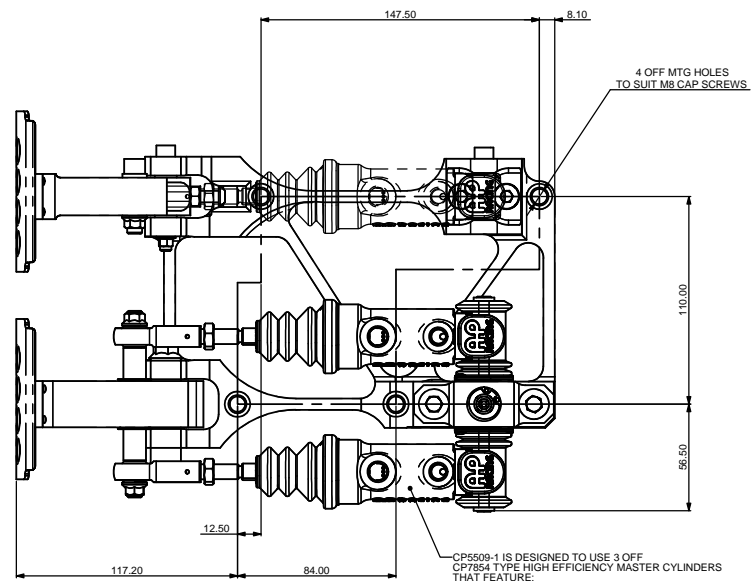
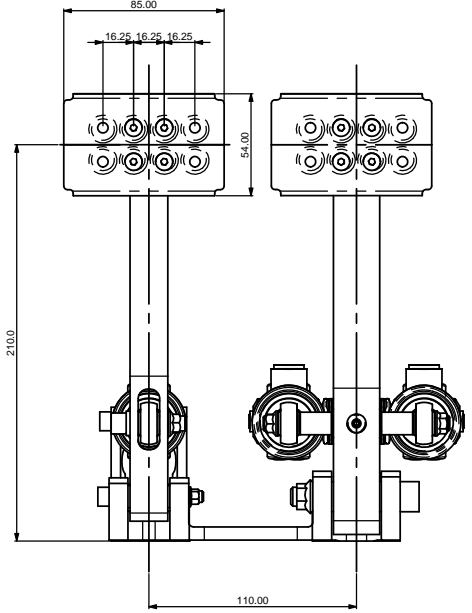

4 OFF MTG HOLES TO SUIT M8 CAP SCREWS

CP5509-1 IS DESIGNED TO USE 3 OFF CP7854 TYPE HIGH EFFICIENCY MASTER CYLINDERS THAT FEATURE:

- BUILT-IN LOW FRICTION CLEVIS
- 7/16"x20 UNF INLET THREAD
- 3/8"x24 UNF OUTLET THREAD
- VARIOUS SIZES AVAILABLE (MASTER CYLINDERS SOLD SEPARATELY)
- \*MINIMUM PIPE FOR INLET - 3"

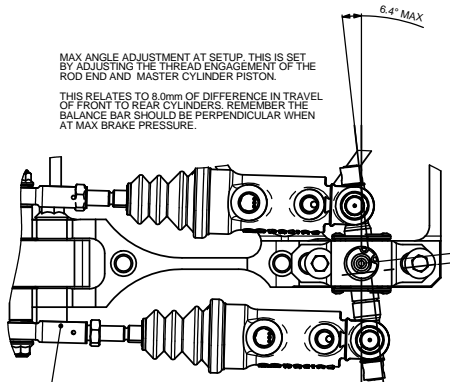

MAX ANGLE ADJUSTMENT AT SETUP. THIS IS SET BY ADJUSTING THE THREAD ENGAGEMENT OF THE ROD END AND MASTER CYLINDER PISTON.

THIS RELATES TO 8.0mm OF DIFFERENCE IN TRAVEL OF FRONT TO REAR CYLINDERS. REMEMBER THE BALANCE BAR SHOULD BE PERPENDICULAR WHEN AT MAX BRAKE PRESSURE.

\*\*IMPORTANT NOTE: BRAKE PIPES MUST NOT RESTRICT THE OPERATION OR ADJUSTMENT OF THE BALANCE BAR\*\*

RECOMMENDED ADJUSTMENT 5.00 MAX. THE MORE ADJUSTMENT YOU HAVE THE MORE INEFFICIENT THE BALANCE BAR BECOMES

**SETTING UP THE BALANCE BAR**

8.00 MIN THREAD ENGAGEMENT, 16.00 MAX THREAD ENGAGEMENT (ALL DRAWING VIEWS SHOWN WITH MINIMUM 8.00 MIN THREAD ENGAGEMENT)

ADJUST THE PUSHRODS SO THAT THE BALANCE BAR IS PERPENDICULAR TO THE PUSHRODS UNDER MAXIMUM LOAD. THE SYSTEM IS THEN SQUARE. IT IS NOT IMPORTANT THAT THE SYSTEM IS SQUARE WHEN RELEASED, BUT IT HAS TO BE UNDER LOAD.

FOR MAXIMUM EFFICIENCY, IT IS RECOMMENDED THAT THE PEDAL IS AT RIGHT ANGLE WITH THE PUSHRODS UNDER MAXIMUM BRAKING LOAD, AND ALSO KEEPING THE BALANCE BAR CENTRAL WITH BETTER SELECTION OF MASTER CYLINDER SIZES HELPS REDUCE INEFFICIENCIES.

ALSO MAKE SURE THAT THE MASTER-CYLINDER PISTONS FULLY RETURN BEFORE USE. THIS CAN BE CHECKED BY FEELING THE PUSHRODS FOR SLIGHT MOVEMENTS THERE SHOULD NOT BE ANY EXCESSIVE LOOSE MOVEMENT.

Alterations		Rev	By	Date
1	12/10/05 B4369		JH	
2	16/09/2007		DRA	
3	20/03/08 B5140		DRA	
4	24/09/09 B5656		COA	
5	17/11/09 B5732		RLB	
6	16/10/13 B6922_02		JH	

SCALE 1:1	SHEET 1 OF 3
DRAWN heritage	
APPROVED	
DERIVED FROM	
TITLE	
FLOOR MTG PUSH TYPE PEDAL BOX INSTALLATION	
DRG NO.	CP5509-1

# A0 INSTALLATION DRAWING

IF THIS DOCUMENT IS PRINTED IN HARD COPY, IT IS FOR INFORMATION USE ONLY AND THEREFORE IS NOT SUBJECT TO UPDATING CONTROLS. ALWAYS REFER TO SOLIDWORKS VIEWER FOR LATEST ISSUE

FIRST ANGLE PROJECTION

THIS DRAWING IS CONFIDENTIAL AND IS SUPPLIED ON THE EXPRESS CONDITION THAT IT SHALL NOT BE LOANED OR COPIED OR DISCLOSED TO ANY OTHER PERSON OR USED FOR ANY OTHER PURPOSE WITHOUT THE WRITTEN CONSENT OF AP RACING LTD.



AP Racing  
Wheller Road  
Coventry  
CV3 4LB  
Tel: +44 (0)24 7663 9595  
Fax: +44 (0)24 7663 9599  
e-mail: sales@apracings.co.uk  
© AP Racing Ltd. 2005  
Web site: HTTP://www.apracings.com

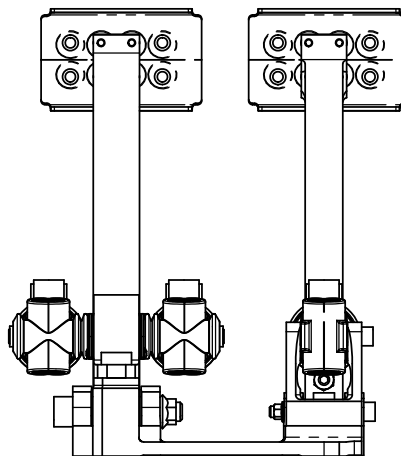
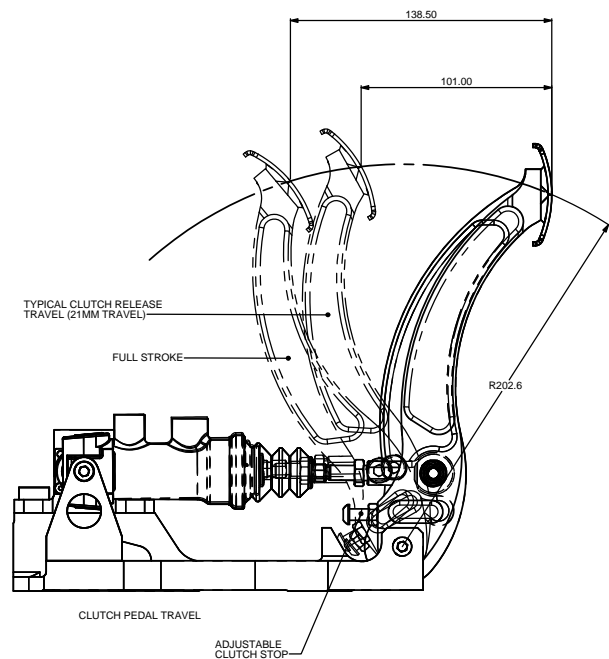

FOR OPTIMUM EFFICIENCY THE PEDAL BOX SHOULD BE SET-UP SO THAT THE MASTER CYLINDER CENTRE LINE & PEDAL PIVOTS ARE SQUARE UNDER MAXIMUM BRAKE LOAD AS SHOWN

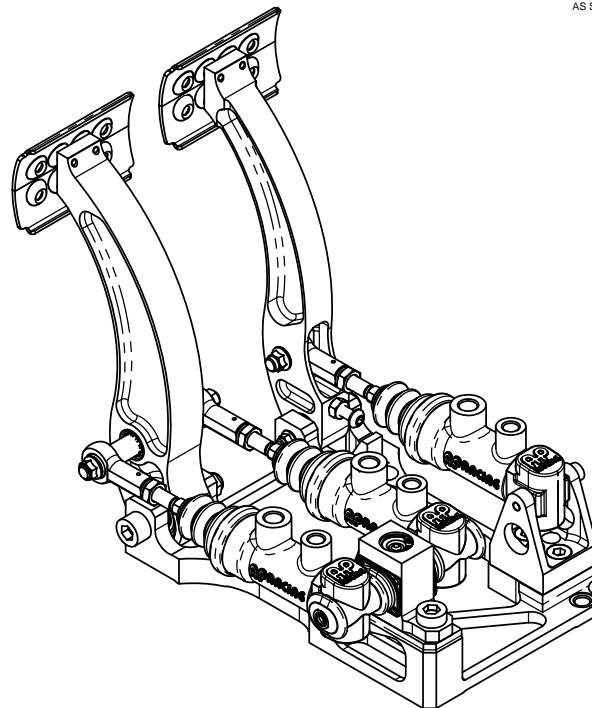
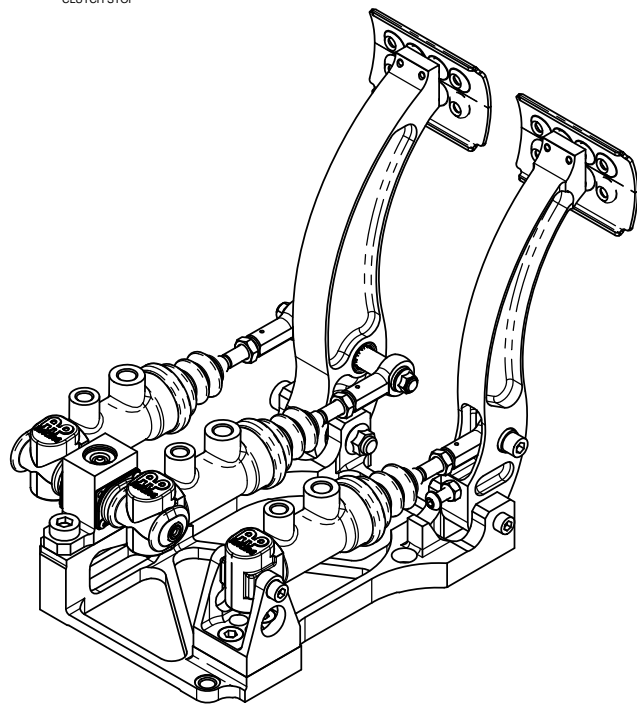

Alterations		Date & No.	Particulars	Zone	Index
1			SEE SHEET 1 FOR ISSUE INFORMATION.		

SCALE 1:1	SHEET 2 OF 3
DRAWN heritage	
APPROVED	
DERIVED FROM	
TITLE FLOOR MTG PUSH TYPE PEDAL BOX INSTALLATION	
DRG NO.	CP5509-1

# A0 INSTALLATION DRAWING

IF THIS DOCUMENT IS PRINTED IN HARD COPY, IT IS FOR INFORMATION USE ONLY AND THEREFORE IS NOT SUBJECT TO UPDATING CONTROLS. ALWAYS REFER TO SOLIDWORKS VIEWER FOR LATEST ISSUE

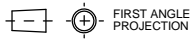

THIS DRAWING IS CONFIDENTIAL AND IS SUPPLIED ON THE EXPRESS CONDITION THAT IT SHALL NOT BE LOANED OR COPIED OR DISCLOSED TO ANY OTHER PERSON OR USED FOR ANY OTHER PURPOSE WITHOUT THE WRITTEN CONSENT OF AP RACING LTD.

**AP RACING**  
 AP Racing  
 Wheeler Road  
 Coventry  
 CV3 4LB  
 Tel: +44 024 7663 9595  
 Fax: +44 024 7663 9559  
 e-mail: sales@apracings.co.uk  
 © AP Racing Ltd. 2005  
 Web site: HTTP://www.apracings.com

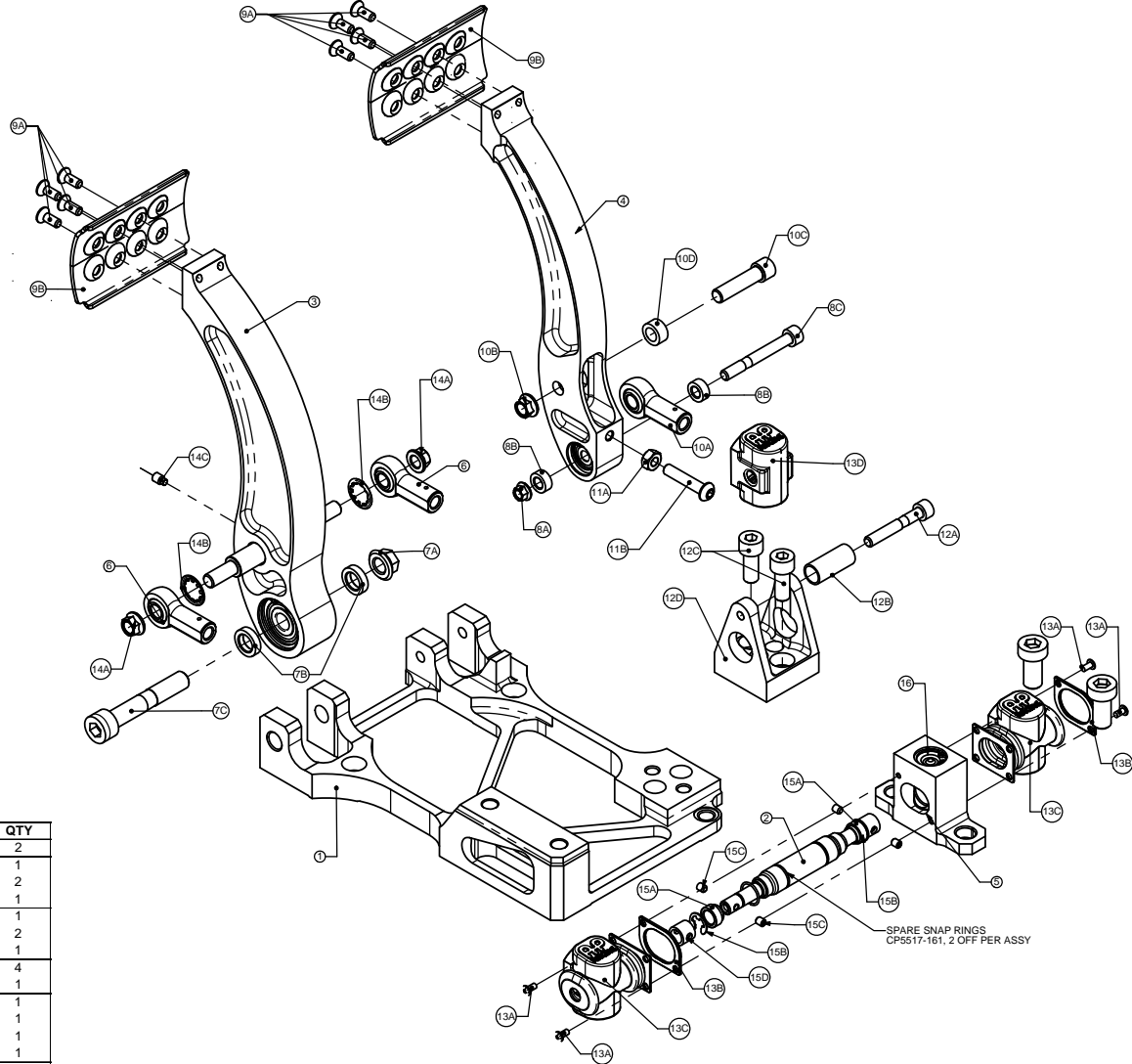

**PARTS**

REF	PART NO.	DESCRIPTION
1	CP5509-101	BASEPLATE
2	CP5517-157	HEAVY DUTY BALANCE BAR

**SUB ASSEMBLIES**

REF	PART NO.	DESCRIPTION
3	CP5509-3	BRAKE PEDAL SUB ASSY (INCLUDES PUSH ROD, STAR WASHERS & GRUB SCREW)
4	CP5509-4	CLUTCH PEDAL SUB ASSY
5	CP5520-4	BALACE BAR HOUSING SUB ASSY (INCL. INTERNALS)

**KITS**

REF	PART NO.	DESCRIPTION	SUFFIX	COMPONENT DESCRIPTION	QTY
6	CP5509-11	BRAKE ROD-END KIT	A	ROD END	2
7	CP5517-25	BRAKE PEDAL PIVOT KIT	A	NUT M10x1.50	1
			B	SPACER RING	2
			C	M10x1.50 CAP SCREW	1
8	CP5509-12	CLUTCH PEDAL PIVOT KIT	A	NUT M6x1.0	1
			B	SPACER RING	2
			C	M6x1.0 CAP SCREW	1
9	CP5509-5	FOOT PAD KIT	A	10-32UNF CSK SCREW	4
			B	FOOT PAD	1
10	CP5509-6	CLUTCH ROD-END KIT	A	ROD-END	1
			B	NUT	1
			C	CAP SCREW	1
			D	SLEEVE	1
11	CP5509-7	CLUTCH STOP KIT	A	M6x1.0 NUT	1
			B	M6x1.0 BUTTON SCREW	1
12	CP5509-8	CLUTCH MASTER CYLINDER MTG KIT	A	M6x1.0 CAP SCREW	1
			B	SLEEVE	1
			C	M8x1.25x20 CAP SCREW	2
			D	MTG BRACKET	1
13	CP5516-20	RUBBER BOOT KIT	A	M3x0.5 BUTTON SCREW	4
			B	CLAMPING PLATE	2
			C	RUBBER BOOT	2
			D	RUBBER BOOT	1
14	CP5509-10	PUSH BAR FIXING KIT	A	NUT	2
			B	STAR WASHER	2
			C	M5x0.8 GRUB SCREW	1
15	CP5517-30	BALANCE BAR EXTRAS KIT	A	BALANCE BAR SPACER	2
			B	CIRCLIP	2
			C	GRUB SCREW M4 x 5.0	4
			D	SLEEVE	2
16	CP5508-25	BALANCE BAR HSG INTERNALS KIT			

CP5508-25 BALANCE BAR HSG INTERNALS KIT WILL ENABLE YOU TO REPLACE THE INTERNALS OF THE HOUSING AND COMPRISES 1 BARREL NUT, 2 BEARINGS AND 2 CIRCLIPS

Alterations		Date & No.	Particulars	Zone	Index
			SEE SHEET 1 FOR ISSUE INFORMATION.		

SCALE 1:1 SHEET 3 OF 3

DRAWN heritage

APPROVED

DERIVED FROM

TITLE  
 FLOOR MTG PUSH TYPE  
 PEDAL BOX INSTALLATION

DRG NO. CP5509-1