

A0 INSTALLATION DRAWING

IF THIS DOCUMENT IS PRINTED IN HARD COPY, IT IS FOR INFORMATION USE ONLY AND THEREFORE IS NOT SUBJECT TO UPDATING CONTROLS. ALWAYS REFER TO SOLIDWORKS VIEWER FOR LATEST ISSUE

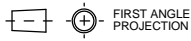

THIS DRAWING IS CONFIDENTIAL AND IS SUPPLIED ON THE EXPRESS CONDITION THAT IT SHALL NOT BE LOANED OR COPIED OR DISCLOSED TO ANY OTHER PERSON OR USED FOR ANY OTHER PURPOSE WITHOUT THE WRITTEN CONSENT OF AP RACING LTD.

AP RACING
 AP Racing Road
 Coventry
 CV3 4LB
 Tel: +44 024 7663 9595
 Fax: +44 024 7663 9599
 e-mail: sales@apracings.co.uk
 © AP Racing Ltd. 2005 Web site: HTTP://www.apracings.com

GENERAL DESCRIPTION
 THIS A GENERAL PURPOSE FLOOR MOUNTED PEDAL BOX WITH FORWARD FACING PUSH TYPE MASTER CYLINDERS.

- FEATURES**
- LIGHTWEIGHT ALUMINIUM BILLET BASE
 - DESIGNED FOR USE WITH CP7854 TYPE MASTER CYLINDERS SEE CP7854-10CD FOR MASTER CYLINDER DETAILS
 - ADJUSTABLE FOOT PADS FOR OPTIMUM DRIVER COMFORT
 - ADJUSTABLE CLUTCH STOP
 - 4.8:1 BRAKE AND CLUTCH PEDAL RATIO
 - BALL BEARINGS BRAKE & CLUTCH PIVOTS TO REDUCE LOSSES & GIVE SMOOTH OPERATION
 - PEDAL BOX WEIGHT, WITHOUT MASTER CYLINDERS, 1.75 Kg.

PART NUMBER
 CP5509-1 - BRAKE AND CLUTCH PEDAL BOX (EXCLUDING MASTER CYLINDERS)

NOTE:-
 A TRAVEL SENSOR KIT TO SUIT THE MASTER CYLINDERS USED WITH THIS PEDAL BOX IS AVAILABLE UNDER THE PART No. CP5854-10.
 THE TRAVEL SENSOR MOUNTS ONTO THE CYLINDER. FOR INSTALLATION DATA SEE DRAWING CP5854-10CD.

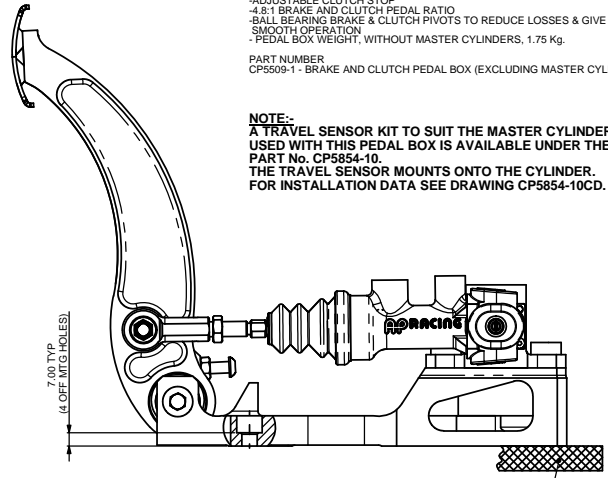

IN ADDITION TO SUPPORTING THE PEDAL BOX UNDERNEATH THE FOUR MOUNTING HOLES, THE PEDAL BOX MUST BE FULLY SUPPORTED UNDERNEATH THE BALANCE BAR HOUSING AS SHOWN

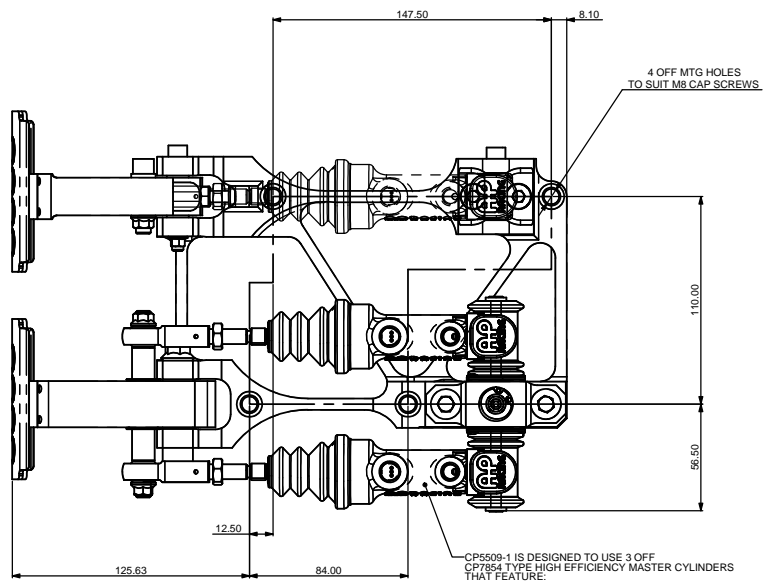
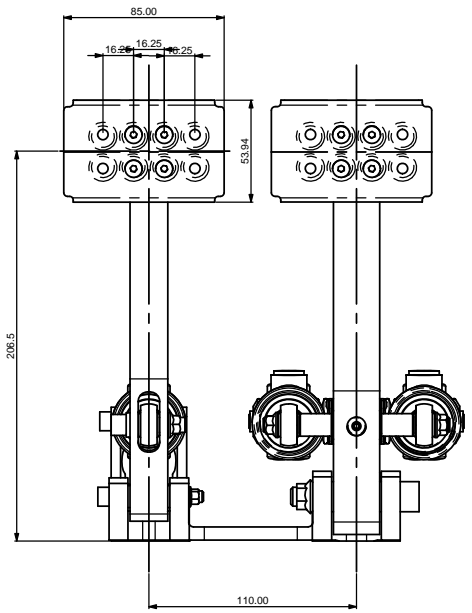

4 OFF MTG HOLES TO SUIT M8 CAP SCREWS

CP5509-1 IS DESIGNED TO USE 3 OFF CP7854 TYPE HIGH EFFICIENCY MASTER CYLINDERS THAT FEATURE:

- BUILT-IN LOW FRICTION CLEVIS
- 7/16"x20 UNF INLET THREAD
- 3/8"x24 UNF OUTLET THREAD
- VARIOUS SIZES AVAILABLE (MASTER CYLINDERS SOLD SEPARATELY)
- *MINIMUM PIPE FOR INLET - 3"

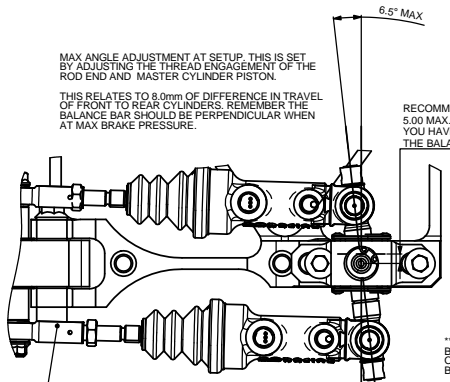

MAX ANGLE ADJUSTMENT AT SETUP. THIS IS SET BY ADJUSTING THE THREAD ENGAGEMENT OF THE ROD END AND MASTER CYLINDER PISTON.
 THIS RELATES TO 8.0mm OF DIFFERENCE IN TRAVEL OF FRONT TO REAR CYLINDERS. REMEMBER THE BALANCE BAR SHOULD BE PERPENDICULAR WHEN AT MAX BRAKE PRESSURE.

RECOMMENDED ADJUSTMENT 5.00 MAX. THE MORE ADJUSTMENT YOU HAVE THE MORE INEFFICIENT THE BALANCE BAR BECOMES

IMPORTANT NOTE: BRAKE PIPES MUST NOT RESTRICT THE OPERATION OR ADJUSTMENT OF THE BALANCE BAR

8.00 MIN THREAD ENGAGEMENT, 16.00 MAX THREAD ENGAGEMENT (ALL DRAWING VIEWS SHOWN WITH MINIMUM 8.00 MIN THREAD ENGAGEMENT)

SETTING UP THE BALANCE BAR

ADJUST THE PUSHRODS SO THAT THE BALANCE BAR IS PERPENDICULAR TO THE PUSHRODS UNDER MAXIMUM LOAD. THE SYSTEM IS THEN SQUARE. IT IS NOT IMPORTANT THAT THE SYSTEM IS SQUARE WHEN RELEASED, BUT IT HAS TO BE UNDER LOAD.

FOR MAXIMUM EFFICIENCY, IT IS RECOMMENDED THAT THE PEDAL IS AT RIGHT ANGLE WITH THE PUSHRODS UNDER MAXIMUM BRAKING LOAD, AND ALSO KEEPING THE BALANCE BAR CENTRAL WITH BETTER SELECTION OF MASTER CYLINDER SIZES HELPS REDUCE INEFFICIENCIES.

ALSO MAKE SURE THAT THE MASTER-CYLINDER PISTONS FULLY RETURN BEFORE USE. THIS CAN BE CHECKED BY FEELING THE PUSHRODS FOR SLIGHT MOVEMENTS THERE SHOULD NOT BE ANY EXCESSIVE LOOSE MOVEMENT.

Rev	Date & No.	Particulars	By	Check
1	12/10/05 B4369	FIRST ISSUE	JH	JH
2	16/09/2007	NOTE REFERENCE AVAILABILITY OF TRAVEL SENSOR ADDED TO SHEET 1.	#	DRA
3	20/03/08 B5140	SHEET 3 OMITTED REF 14 PARTS NOW SHOWN IN CHART. NEW REF 15 & 16 PARTS ADDED TO CHART.	#	DRA
4	24/09/09 B5656	WEIGHT ADDED.	#	COA
5	17/11/09 B5732	MASTER CYLINDERS CHANGED TO CP7854 TYPE WERE CP5854.	#	RLB
6	16/10/13 B6922_02	NEW BALANCE BAR ADDED CP5520-4	#	JH
7	22/03/2019 B8047	SHEET 3 EXPLODED VIEW ALTERED TO IMPROVE CLARITY OF CLAMPING PLATE ASSEMBLY ORDER	#	E14/JDD
8	26/03/2019 B8047_03	VARIOUS FIXES OF ANNOTATIONS AND TABLES	#	JDD

SCALE 1:1 SHEET 1 OF 3
 DRAWN heritage
 APPROVED
 DERIVED FROM
TITLE
 FLOOR MTG PUSH TYPE
 PEDAL BOX INSTALLATION
DRG NO. CP5509-1

A0 INSTALLATION DRAWING

IF THIS DOCUMENT IS PRINTED IN HARDCOPY, IT IS FOR INFORMATION USE ONLY AND THEREFORE IS NOT SUBJECT TO UPDATING CONTROLS. ALWAYS REFER TO SOLIDWORKS VIEWER FOR LATEST ISSUE

FIRST ANGLE PROJECTION

THIS DRAWING IS CONFIDENTIAL AND IS SUPPLIED ON THE EXPRESS CONDITION THAT IT SHALL NOT BE LOANED OR COPIED OR DISCLOSED TO ANY OTHER PERSON OR USED FOR ANY OTHER PURPOSE WITHOUT THE WRITTEN CONSENT OF AP RACING LTD.

AP RACING
 AP Racing
 Wheeler Road
 Coventry
 CV3 4LB
 Tel: +44 (0)24 7663 9595
 Fax: +44 (0)24 7663 9599
 e-mail: sales@apracings.co.uk
 © AP Racing Ltd. 2005
 Web site: HTTP://www.apracings.com

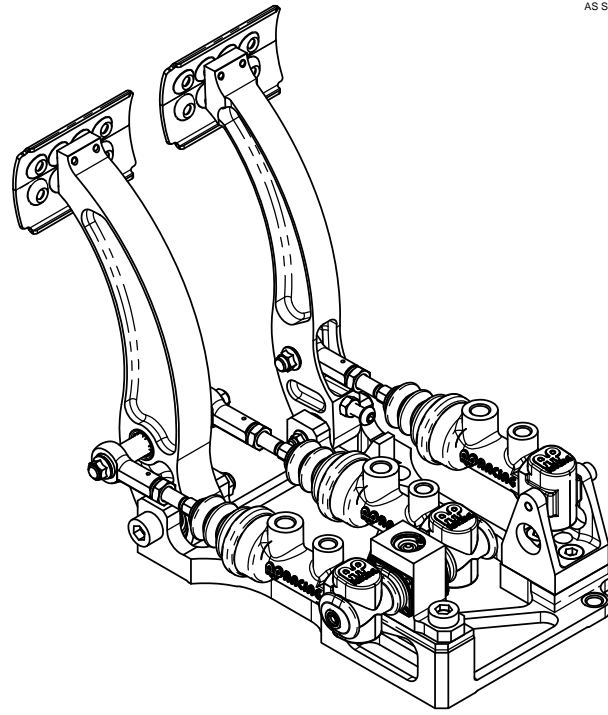
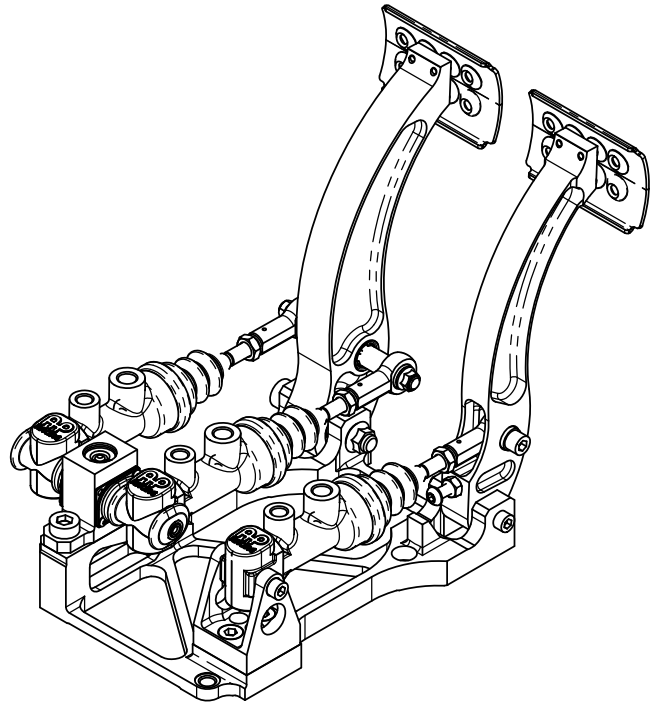
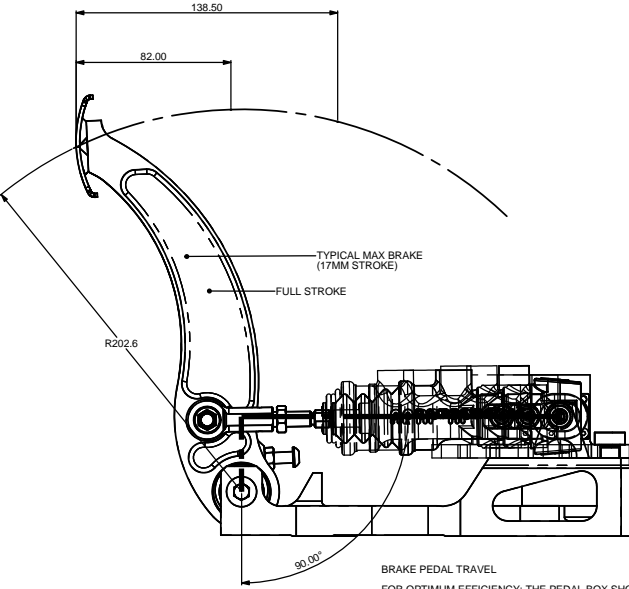
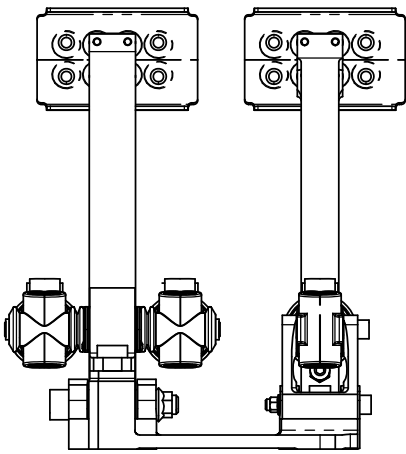
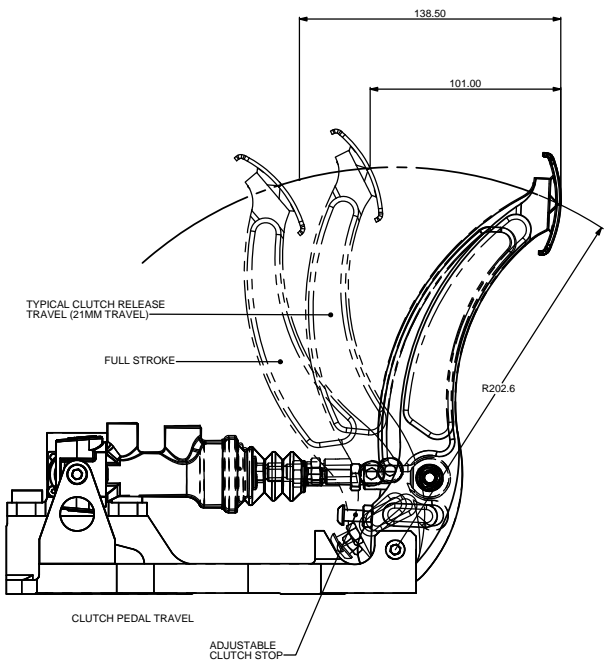

Alterations		Zone	Index
Date & No.	Particulars		
	SEE SHEET 1 FOR ISSUE INFORMATION.		

SCALE 1:1	SHEET 2 OF 3
DRAWN heritage	
APPROVED	
DERIVED FROM	
TITLE	
FLOOR MTG PUSH TYPE	
PEDAL BOX INSTALLATION	
DRG NO.	CP5509-1

A0 INSTALLATION DRAWING

IF THIS DOCUMENT IS PRINTED IN HARD COPY, IT IS FOR INFORMATION USE ONLY AND THEREFORE IS NOT SUBJECT TO UPDATING CONTROLS. ALWAYS REFER TO SOLIDWORKS VIEWER FOR LATEST ISSUE

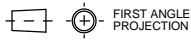

THIS DRAWING IS CONFIDENTIAL AND IS SUPPLIED ON THE EXPRESS CONDITION THAT IT SHALL NOT BE LOANED OR COPIED OR DISCLOSED TO ANY OTHER PERSON OR USED FOR ANY OTHER PURPOSE WITHOUT THE WRITTEN CONSENT OF AP RACING LTD.

AP RACING
 AP Racing
 Wheeler Road
 Coventry
 CV3 4LB
 Tel: +44 (0)24 7663 9595
 Fax: +44 (0)24 7663 9559
 e-mail: sales@apracings.co.uk
 © AP Racing Ltd. 2005 Web site: HTTP://www.apracings.com

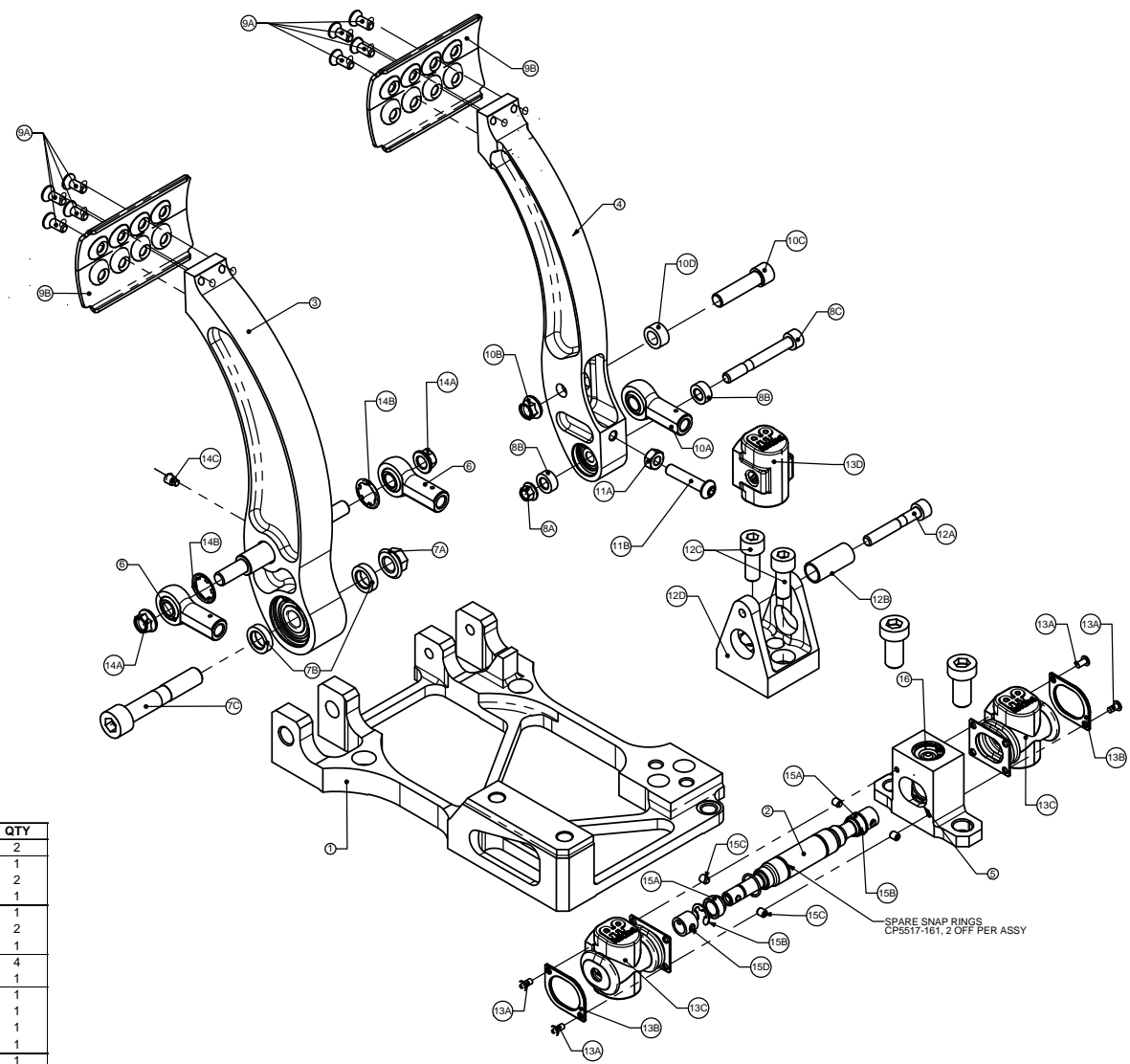

PARTS

REF	PART NO.	DESCRIPTION
1	CP5509-101	BASEPLATE
2	CP5517-157	HEAVY DUTY BALANCE BAR

SUB ASSEMBLIES

REF	PART NO.	DESCRIPTION
3	CP5509-3	BRAKE PEDAL SUB ASSY (INCLUDES PUSH ROD, STAR WASHERS & GRUB SCREW)
4	CP5509-4	CLUTCH PEDAL SUB ASSY
5	CP5520-4	BALANCE BAR HOUSING SUB ASSY (INCL. INTERNALS)

KITS

REF	PART NO.	DESCRIPTION	SUFFIX	COMPONENT DESCRIPTION	QTY
6	CP5509-11	BRAKE ROD-END KIT	A	ROD END	2
7	CP5517-25	BRAKE PEDAL PIVOT KIT	A	NUT M10x1.50	1
			B	SPACER RING	2
			C	M10x1.50 CAP SCREW	1
8	CP5509-12	CLUTCH PEDAL PIVOT KIT	A	NUT M6x1.0	1
			B	SPACER RING	2
			C	M6x1.0 CAP SCREW	1
9	CP5509-5	FOOT PAD KIT	A	10-32UNF CSK SCREW	4
			B	FOOT PAD	1
10	CP5509-6	CLUTCH ROD-END KIT	A	ROD-END	1
			B	NUT	1
			C	CAP SCREW	1
			D	SLEEVE	1
11	CP5509-7	CLUTCH STOP KIT	A	M6x1.0 NUT	1
			B	M6x1.0 BUTTON SCREW	1
12	CP5509-8	CLUTCH MASTER CYLINDER MTG KIT	A	M6x1.0 CAP SCREW	1
			B	SLEEVE	1
			C	M8x1.25x20 CAP SCREW	2
			D	MTG BRACKET	1
13	CP5516-20	RUBBER BOOT KIT	A	M3x0.5 BUTTON SCREW	4
			B	CLAMPING PLATE	2
			C	RUBBER BOOT	2
			D	RUBBER BOOT	1
14	CP5509-10	PUSH BAR FIXING KIT	A	NUT	2
			B	STAR WASHER	2
			C	M5x0.8 GRUB SCREW	1
15	CP5517-30	BALANCE BAR EXTRAS KIT	A	BALANCE BAR SPACER	2
			B	CIRCLIP	2
			C	GRUB SCREW M4 x 5.0	4
			D	SLEEVE	2
16	CP5508-25	BALANCE BAR HSG INTERNALS KIT		CP5508-25 BALANCE BAR HSG INTERNALS KIT WILL ENABLE YOU TO REPLACE THE INTERNALS OF THE HOUSING AND COMPRISES 1 BARREL NUT, 2 BEARINGS AND 2 CIRCLIPS	

Alterations		Date & No.	Particulars	Zone	Initials
			SEE SHEET 1 FOR ISSUE INFORMATION.		

SCALE 1:1 SHEET 3 OF 3
 DRAWN: heritage
 APPROVED:
 DERIVED FROM:
 TITLE: FLOOR MTG PUSH TYPE PEDAL BOX INSTALLATION
 DRG NO.: CP5509-1