

A0 INSTALLATION DRAWING

IF THIS DOCUMENT IS PRINTED IN HARD COPY, IT IS FOR INFORMATION USE ONLY AND THEREFORE IS NOT SUBJECT TO UPDATING CONTROLS. ALWAYS REFER TO SOLIDWORKS VIEWER FOR LATEST ISSUE



THIS DRAWING IS CONFIDENTIAL AND IS SUPPLIED ON THE EXPRESS CONDITION THAT IT SHALL NOT BE LOANED OR COPIED OR DISCLOSED TO ANY OTHER PERSON OR USED FOR ANY OTHER PURPOSE WITHOUT THE WRITTEN CONSENT OF AP RACING LTD.

AP Racing
Wheler Road
Coventry
CV3 4LB
Tel: +44 (024) 7663 9595
Fax: +44 (024) 7663 9559
e-mail: sales@apracings.co.uk
Web site: HTTP://www.apracings.com

© AP Racing Ltd. 2005

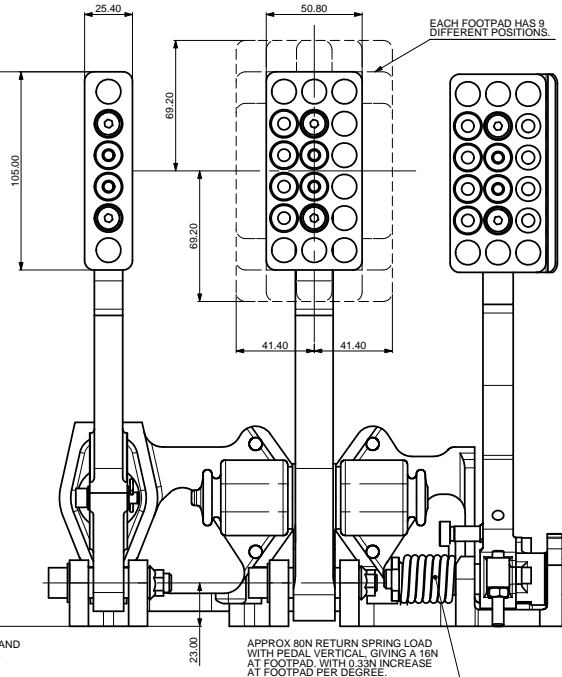
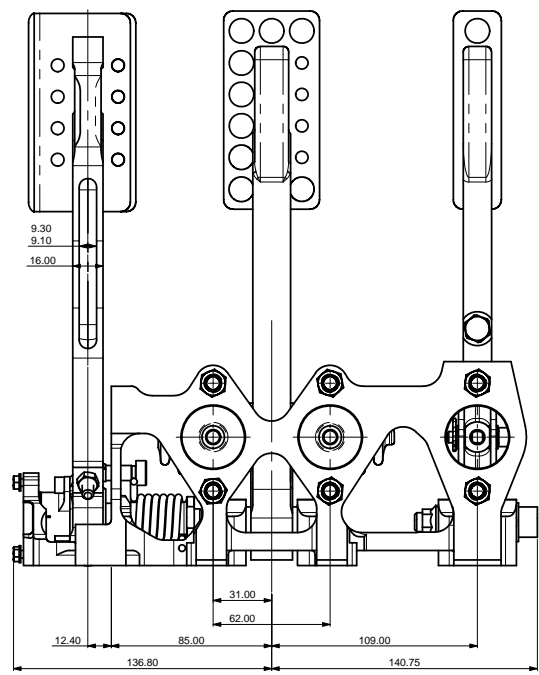
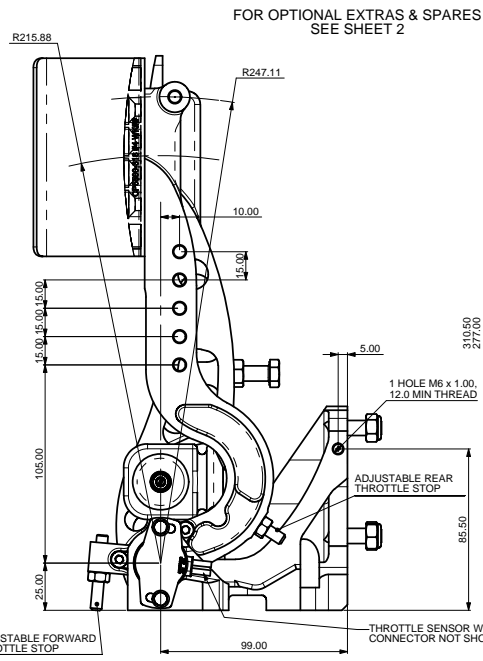
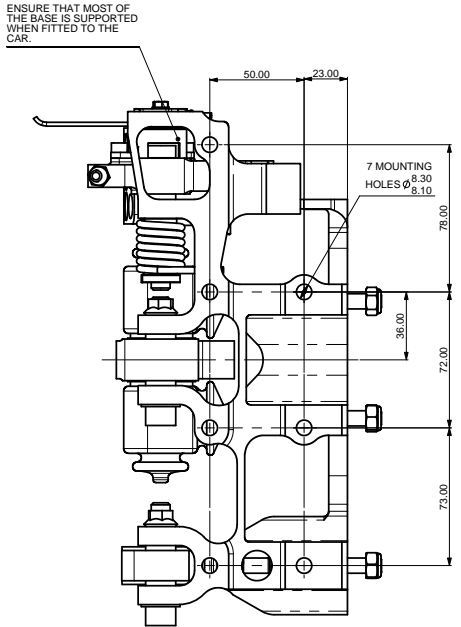

GENERAL DESCRIPTION
THIS PEDAL BOX IS A GENERIC RACING PEDAL BOX DESIGN, DESIGNED FOR COMFORT AND CONTROL. THIS UPDATED PEDAL BOX HAS A NEW OPTIMISED MACHINED FROM BILLET BASEPLATE AND PEDALS. THE THROTTLE HAS BEEN UPDATED TO ADD ADDITIONAL FEATURES TO AID CONNECTION TO BELL CRANKS AND CABLES.

- FEATURES**
- OPTIMISED, LIGHTWEIGHT, MACHINED FROM BILLET BASE PLATE.
 - OPTIMISED, LIGHTWEIGHT CLUTCH AND BRAKE PEDAL, WITH IMPROVED TWIST DISPLACEMENT.
 - NEW THROTTLE PEDAL WITH ADDITIONAL FEATURES.
 - ADJUSTABLE RATIO PEDALS.
 - ALL THREADS ARE METRIC, EXCEPT THOSE MENTIONED BELOW.
 - Ø10 BALANCE BAR
 - ADJUSTABLE STOPS ON CLUTCH AND THROTTLE PEDALS.
 - PEDAL BOX WEIGHT IS 2.8 Kg
BALANCE BAR ADJUSTER CABLE WEIGHT 236 g
(CP2623 MASTER CYLINDERS APPROX 0.31Kg EACH)
 - CABLE ADJUSTER INCLUDED.
 - ALL PEDALS HAVE BALL BEARING PIVOTS.
 - OPTIONAL ROTARY HALL EFFECT SENSOR (WITH PLUG) ON THROTTLE, SEE SHEET 2 FOR DETAILS

PART NUMBERS	CLEVIS THREADS		THROTTLE SENSOR	
	METRIC M8x1.25	IMPERIAL 5/16" UNF	INCLUDED	NOT INCLUDED
CP5500-605MTS	✓	✗	✓	✗
CP5500-605M	✓	✗	✗	✓
CP5500-605UTS	✗	✓	✓	✗
CP5500-605U	✗	✓	✗	✓

BORE SIZE	BRAKE PEDAL	CLUTCH PEDAL
Ø14.0mm (0.551")	CP2623-88PRM088	CP2623-88PRM088
Ø15.0mm (0.591")	CP2623-89PRM088	CP2623-89PRM088
Ø15.9mm (0.625") 5/8"	CP2623-90PRM088	CP2623-90PRM088
Ø16.8mm (0.661")	CP2623-905PRM088	CP2623-905PRM088
Ø17.8mm (0.700")	CP2623-91PRM088	CP2623-91PRM088
Ø19.1mm (0.750") 3/4"	CP2623-92PRM088	CP2623-92PRM088
Ø20.6mm (0.842") 13/16"	CP2623-93PRM088	CP2623-93PRM088
Ø22.2mm (0.875") 7/8"	CP2623-94PRM088	CP2623-94PRM088
Ø23.8mm (0.937") 15/16"	CP2623-95PRM088	CP2623-95PRM088
Ø25.4mm (1.000")	CP2623-96PRM088	CP2623-96PRM088

THIS TABLE SHOWS THE RECOMMENDED PUSHROD LENGTHS FOR CYLINDERS IN THIS BOX.

IF YOU ARE ORDERING THE CP5500-505UNF, THEN MAKE SURE YOU ORDER YOUR CYLINDERS WITH THE 'FR' EXTENSION AND NOT THE 'PRM', eg CP2623-91PR088.

CP2623 CYLINDERS HAVE IMPERIAL THREADS ON THE INLET AND OUTLET. FOR METRIC THREADS ORDER CP5623 VERSIONS INSTEAD.

CYLINDERS WITH LONGER PUSHRODS CAN BE CUT DOWN.

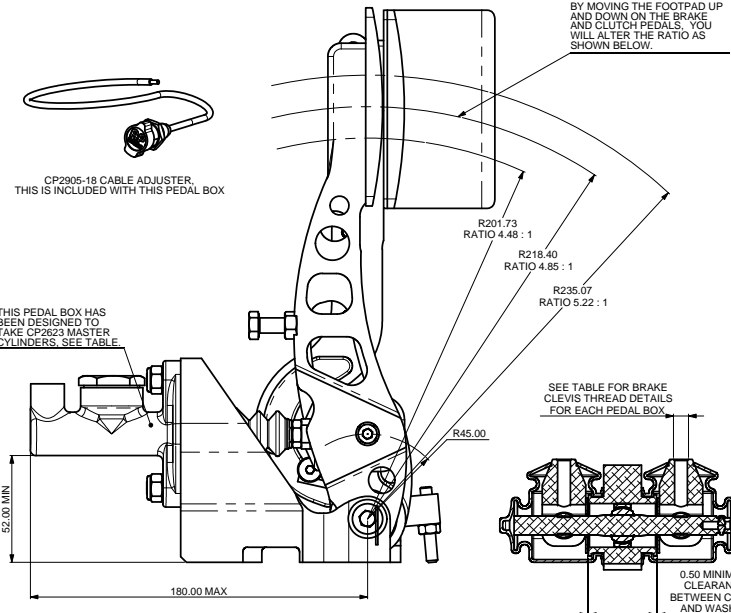

Alterations

#	Date & No.	Particulars	By	Check
1	18/01/2013	FIRST ISSUE		
2	22/01/2013	CLUTCH FOOTPAD MODIFIED. B6637		
3	18/02/2013	BOMS UPDATED ON SHEET 3. B6637		
4	09/04/2013	SENSOR PIN NUMBERS ADDED. B6637		
5	03/02/16	SHEET 3: ITEM 25 - CP5500-373 WAS CP5500-331 ITEM 31 - CP5500-374 WAS CP5500-336 IMPERIAL CLUTCH CLEVIS 41 WAS 44 IMPERIAL BRAKE CLEVIS 42 WAS 45 BOLT AND BUSH NOTE ADDED		
6	14/09/16	SHEET 1: BRAKE CLEVIS THREAD NOTE UPDATED SHEET 3: ITEM 25: CP5500-379 WAS 373		

SCALE 1:1 SHEET 1 OF 3

DRAWN: Chris Arowsmith

APPROVED:

DERIVED FROM:

TITLE: GENERIC FLOOR MTG PEDAL BOX

DRG NO: CP5500-605CD

A0 INSTALLATION DRAWING

IF THIS DOCUMENT IS PRINTED IN HARD COPY, IT IS FOR INFORMATION USE ONLY AND THEREFORE IS NOT SUBJECT TO UPDATING CONTROLS. ALWAYS REFER TO SOLIDWORKS VIEWER FOR LATEST ISSUE

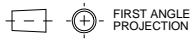

THIS DRAWING IS CONFIDENTIAL AND IS SUPPLIED ON THE EXPRESS CONDITION THAT IT SHALL NOT BE LOANED OR COPIED OR DISCLOSED TO ANY OTHER PERSON OR USED FOR ANY OTHER PURPOSE WITHOUT THE WRITTEN CONSENT OF AP RACING LTD.

AP RACING
 AP Racing
 Wheeler Road
 Coventry
 CV3 4LB
 Tel: +44 024 7663 9595
 Fax: +44 024 7663 9559
 e-mail: sales@ap-racing.co.uk
 © AP Racing Ltd. 2005
 Web site: HTTP://www.ap-racing.com

OPTIONAL EXTRAS

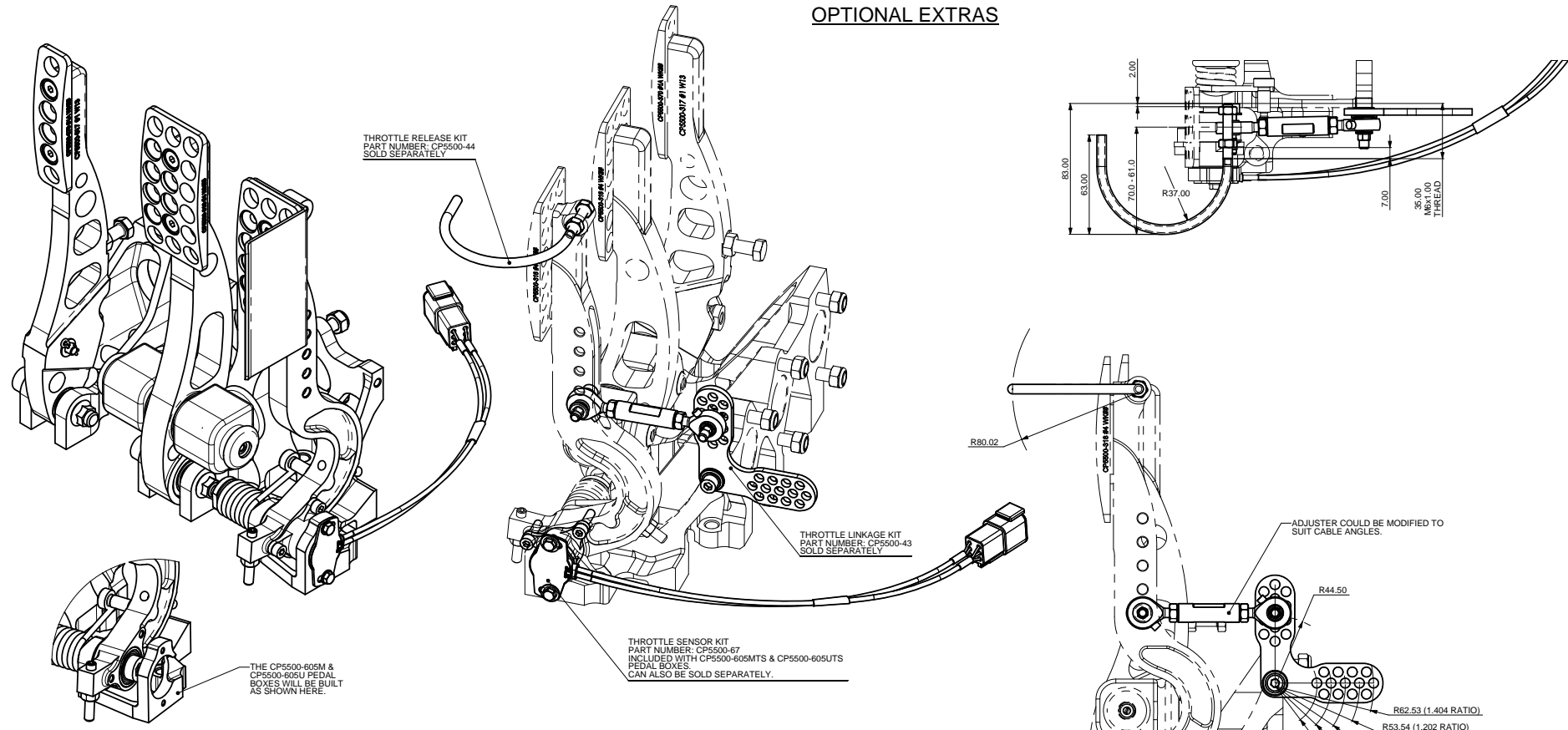

THROTTLE SENSOR DETAIL NON CONTACT ROTARY HALL EFFECT SENSOR WITH DUAL REDUNDANCY

THE THROTTLE SENSOR HAS A MEASURING RANGE OF 30°. THIS ANGLE WAS SELECTED TO PROVIDE A HIGH RESOLUTION OF DATA FROM THE SENSOR, AND BECAUSE THE TYPICAL TRAVEL OF A THROTTLE PEDAL IN THIS RANGE IS WITHIN THIS, THE PEDAL WITH ITS STOPS ARE CAPABLE OF A MUCH BIGGER RANGE (20% FORWARD FROM VERTICAL, 27.5 BACKWARDS FROM VERTICAL), THE PEDAL BOX AS STANDARD WILL BE SET AT 4° FORWARD, TO 24° BACK. IF YOU NEED A DIFFERENT RANGE, ALTER THE FORWARD STOP, ALTER THE BACK STOP (KEEP THE RANGE TO WITHIN 30°), THEN ROTATE THE SENSOR TO AN ANGLE WHERE IS CAN READ YOUR NEW RANGE.

Electrical
 Measurement range 30° (BOTH CHANNELS)
 Supply voltage 5-40.5 Vdc
 Over voltage protection up to 10 Vdc (-40 to 60°C)
 Maximum supply current <12.5 mA each independent supply (<25mA total)
 Reverse polarity protection Yes
 Short circuit protection: Output to GND Yes
 Power-on settlement time Yes
 Resolution 0.025% of measurement range (12 Bit)
 Non-linearity <±0.4 %
 Temperature coefficient <±30 ppm/°C

* Non-linearity is measured using the Least-Squares method on a computerised calibration system

Analog Output
 Voltage output range Vdc Ratimetric output voltage - 2 to 98% of V_s over measurement
 Monotonic range Vdc 0.05 (1%) and 4.95 (99%) nominal
 Load resistance 10k minimum (resistive to GND)
 Output noise <1 mVrms
 Input/output delay <2 mS
 Output direction Channel 1 - CW, Channel 2 - ACW

Mechanical
 Mechanical angle 360°, continuous
 Maximum rotational speed 3600°/sec
 Weight TBA g
 Mounting Use 2 x M4 socket head cap screws and M4 washer - maximum tightening torque 2Nm.
 Phasing When magnet ident mark is facing toward the sensor and cable exit, output is at mid travel. The sensor housing allows for a 10° adjustment via the mounting flange slots.

Environmental
 Protection class IP68 (to 2m depth for 2 hours) and IP69K
 Life This product has no contacting parts.
 Dither life Contactless - no degradation due to shaft dither
 Operational temperature # -40°C to +140°C and +170°C for 72 hours
 Storage temperature -55°C to +140°C
 Vibration BS EN 60068-2-64:1995 Sec 8.4 (31.4g rms) 20 to 2000Hz Random
 Shock 3m drop onto concrete and 2500g
 EMC immunity level BS EN 61000-4-3:1999, to 100V/m, 80MHz to 1GHz and 1.4GHz to 2.7GHz (2004/108/EC)

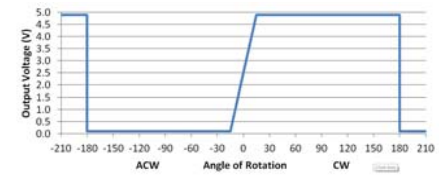
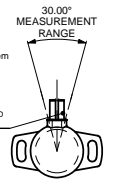

THE GRAPH DATA IS TBC

Alterations		Date & No.	Particulars	Drawn	Checked
0	01/02		SEE SHEET 1 FOR ISSUE INFORMATION.		

SCALE 1:1	SHEET 2 OF 3
DRAWN	Chris Arowsmith
APPROVED	
DERIVED FROM	
TITLE GENERIC FLOOR MTG PEDAL BOX	
DRG NO.	CP5500-605CD

ONLY THE BRAKE PEDAL HAS BEEN TESTED WITH THIS ITEM FITTED. IT SHOULD NOT BE FITTED TO THE CLUTCH OR THROTTLE PEDALS.

A0 INSTALLATION DRAWING

IF THIS DOCUMENT IS PRINTED IN HARD COPY, IT IS FOR INFORMATION USE ONLY AND THEREFORE IS NOT SUBJECT TO UPDATING CONTROLS. ALWAYS REFER TO SOLIDWORKS VIEWER FOR LATEST ISSUE

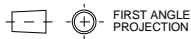

THIS DRAWING IS CONFIDENTIAL AND IS SUPPLIED ON THE EXPRESS CONDITION THAT IT SHALL NOT BE LOANED OR COPIED OR DISCLOSED TO ANY OTHER PERSON OR USED FOR ANY OTHER PURPOSE WITHOUT THE WRITTEN CONSENT OF AP RACING LTD.

AP RACING
 AP Racing Ltd. 2005
 AP Racing
 Wheeler Road
 Coventry
 CV3 4LB
 Tel: +44 (0)24 7663 9595
 Fax: +44 (0)24 7663 9559
 e-mail: sales@apracings.co.uk
 Web site: HTTP://www.apracings.com

SPARES LIST

ITEM NO.	PART NUMBER	DESCRIPTION	Metric Version Quantity	Imperial Version Quantity
1	CP5500-360	BASE PLATE	1	1
2	CP5500-133	STUD M8x1.25, 28.0 LONG	6	6
3	CP5500-41	CLUTCH PEDAL SUB-ASSY	1	1
4	CP5119-134	RETAINING R CLIP	1	1
5	CP5507-131	GLYD RING BEARING	2	2
6	CP2494-1305	WASHER	2	2
7	CP5500-314	METRIC CLUTCH CLEVIS	1	-
8	CP5500-134	M8 x 1.50 HEX BOLT	1	1
9	CP5500-323	CLUTCH CLEVIS PIVOT RETAINER	1	1
10	ME21002	M8 LOCK NUT	1	1
11	CP5518-127	SPACER	5	5
12	CP5500-370	FOOTPAD	1	1
13	CP5500-40	BRAKE PEDAL SUB-ASSY	1	1
14	CP5500-124	WASHER	2	2
15	CP5500-312	CLEVIS - METRIC	2	-
16	CP5500-108	BARREL NUT	2	2
17	CP5500-150	RUBBER BOOT	2	2
18	CP5500-148	SNAP RING 0.4375"	2	2
19	CP5500-113st	SCREW M4 x 5	2	2
20	CP5500-105	BALANCE BAR	1	1
21	CP5500-318	FOOTPAD	2	2
22	CP7000-170	WASHER	2	2
23	CP4350-106	M6 x 14 SCREW, COUNTERSUNK	6	6
24	CP5500-46	THROTTLE PEDAL SUB-ASSY	1	1
25	CP5500-379	M10x57x1.50 BOLT	1	1
26	CP5500-338	M6 SCREW x 40, FLAT GRUB	1	1
27	ME21001	M6 x 1.00 NUT	2	2
28	CP5500-324	M6 SCREW x 30, FLAT GRUB	1	1
29	CP7033-111	M6 SCREW, Ø8 SHOULDER	1	1
30	CP5500-329	THROTTLE GUARD	1	1
31	CP5500-374	SPRING SUPPORT BUSH	1	1
32	CP5500-365	TORSION SPRING	1	1
33	CP5000-425	M10x58 CALIPER M10 BOLT	1	1
34	CP5200-150	WASHER	2	2
35	CP5427-101	M10 KAYLOCK NUT	2	2
36	CP5200-173	M10x58 CALIPER M10 BOLT	1	1
37	CP4612-109	M5 x 0.80 CAP HEAD	2	2
38	CP5500-364	DEBRIS SLEEVE	1	1
39	CP4028-114	M4 x 0.7 HEX HEAD SCREW, 8.00 LONG	2	2
40	CP5500-369	ROTARY SENSOR	1	1
41	CP5500-336	UNF CLUTCH CLEVIS	-	1
42	CP5500-345	CLEVIS - UNF	-	2
43	CP5500-339	SPHERICAL BEARING	1	1
44	CP5500-363	MAGNET HOLDER	1	1
45	CP5500-346	M8 NYLOC NUT	6	6

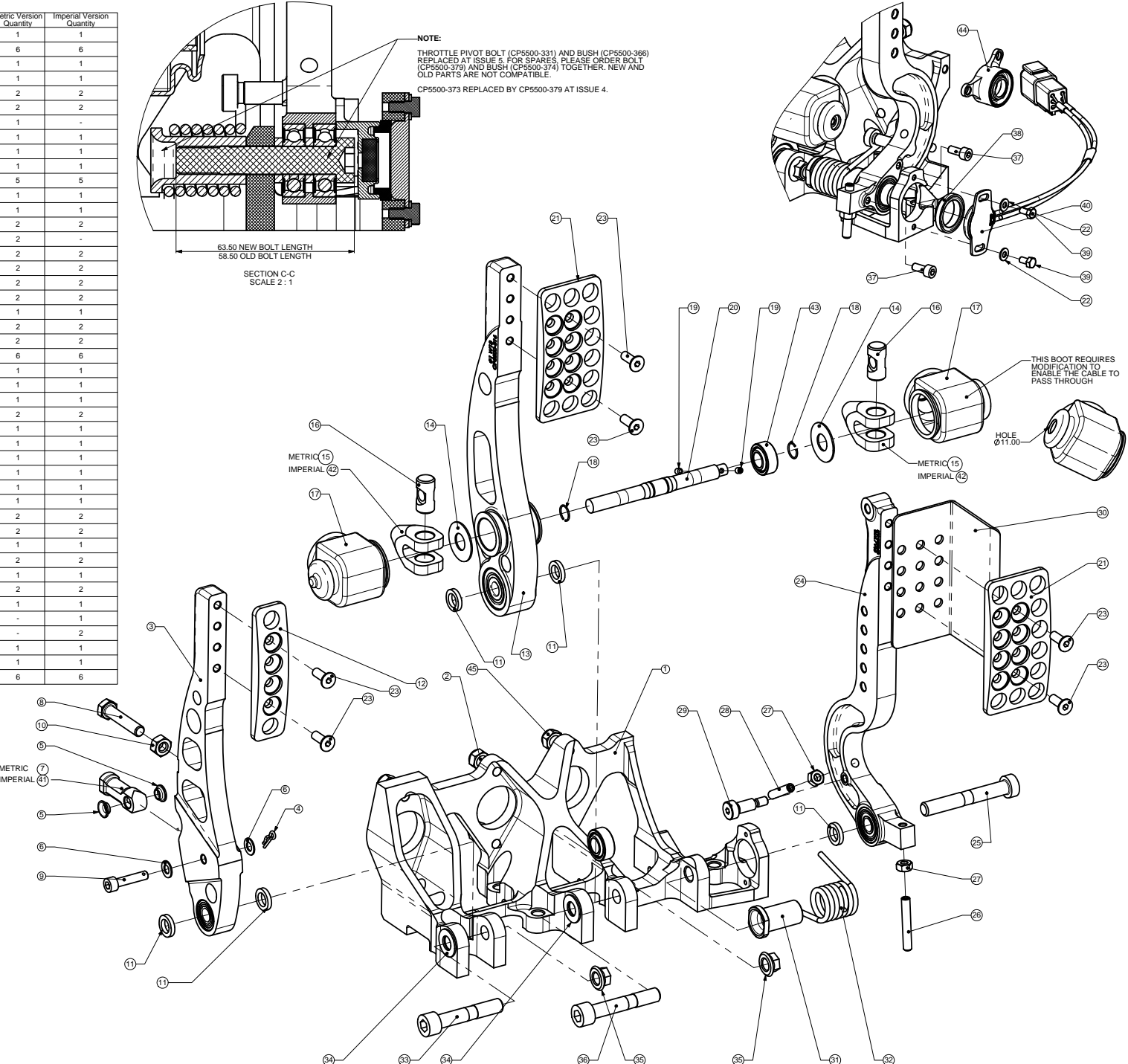
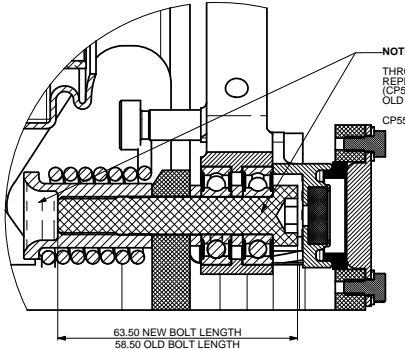

Alterations		Date & No.	Particulars	Drawn	Checked
1			SEE SHEET 1 FOR ISSUE INFORMATION.		

SCALE 1:1	SHEET 3 OF 3
DRAWN	Chris Arnsworth
APPROVED	
DERIVED FROM	
TITLE	
GENERIC FLOOR MTG	
PEDAL BOX	
DRG NO.	CP5500-605CD