

B1 INSTALLATION DRAWING

IF THIS DOCUMENT IS PRINTED IN HARDCOPY, IT IS FOR INFORMATION USE ONLY AND THEREFORE IS NOT SUBJECT TO UPDATING CONTROLS. ALWAYS REFER TO SOLIDWORKS VIEWER FOR LATEST ISSUE



FIRST ANGLE PROJECTION

THIS DRAWING IS CONFIDENTIAL AND IS SUPPLIED ON THE EXPRESS CONDITION THAT IT SHALL NOT BE LOANED OR COPIED OR DISCLOSED TO ANY OTHER PERSON OR USED FOR ANY OTHER PURPOSE WITHOUT THE WRITTEN CONSENT OF AP RACING LTD.



AP Racing
Wheler Road
Coventry
CV3 4LB
Tel: +44 024 7663 9595
Fax: +44 024 7663 9559
e-mail: sales@apracing.co.uk
Web site: HTTP://www.apracing.com

© AP Racing Ltd. 2005

Issue No	Alterations		
	Date & No.	Particulars	Zone / Initials
1	17/07/10 B5692	FIRST ISSUE	JH
2	12/01/12	PAD REFERENCE CORRECTED: CP6820D46 WAS CP6821D46 & VOLUME 67.9cm³ WAS 61.7cm³	JH

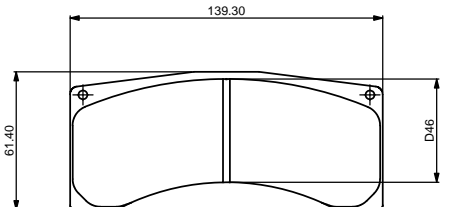
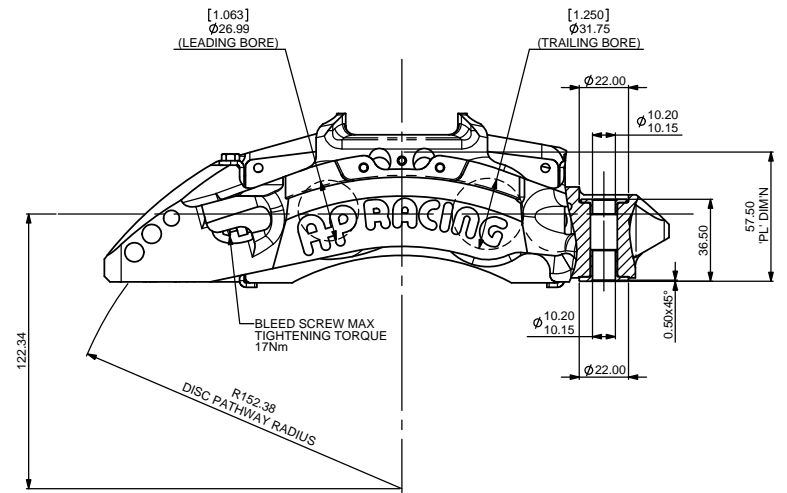
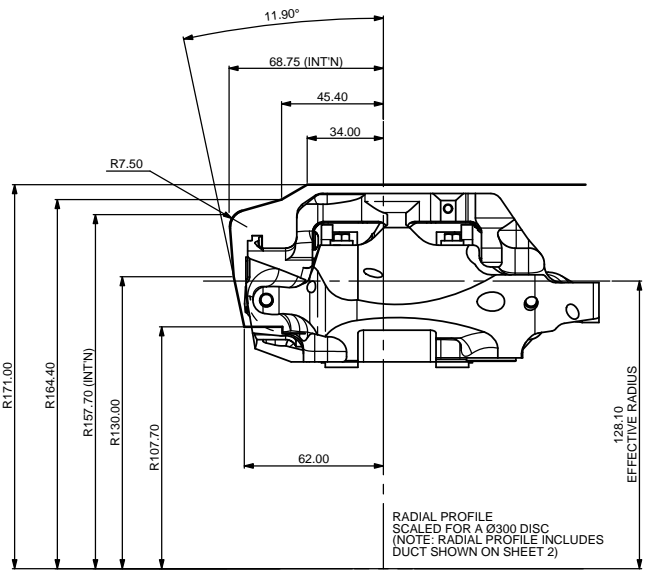

CP6820D46 FAMILY IRON PAD
AREA - 61.70CM²
THICKNESS - 1.6CM
VOLUME - 67.9CM³

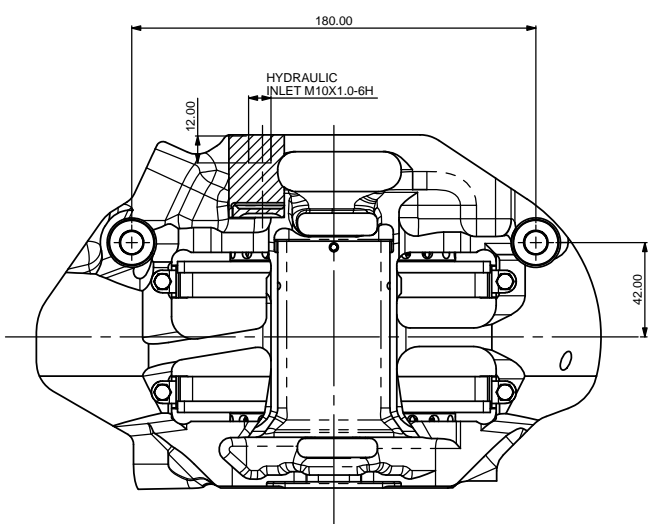

GENERAL DESCRIPTION:
4 PISTON DIFFERENTIAL BORE CALIPER TO SUIT UP TO Ø300 x 32 IRON DISC

APPLICATION:
S2000 RALLY - REAR

TECHNICAL INFORMATION:
TOTAL PISTON AREA: 27.3cm²
PISTON MATERIAL: STAINLESS STEEL
BODY MATERIAL: ALUMINIUM ALLOY
APPROXIMATE ASSEMBLY WEIGHT: 1.68Kg

INSTALLATION INFORMATION
DISC & CALIPER MOUNTING TOLERANCES TO BE SUCH THAT THE DISC IS CENTRAL TO THE CALIPER TO WITHIN ±0.5mm.
CALIPER TO BE MOUNTED WITHIN ±15° FROM VERTICAL.
DISC DIAMETRAL CLEARANCE SHOULD BE 2.5mm NOM. FROM DISC O.D. TO PATHWAY.
BLEED SCREW MAX. TIGHTENING TORQUE 17Nm

KEY TO DIMENSIONS:
PL: TOP OF PAD MATERIAL TO MOUNTING BOSS FACE WITH PAD SITTING DOWN ON LEDGE.

CALIPER PART NUMBERS
CP6831-4S4LP - RIGHT HAND LEADING (IN FRONT OF AXLE)
CP6831-5S4LP - LEFT HAND LEADING (IN FRONT OF AXLE)

SCALE 1:1	SHEET 1 OF 3
DRAWN jheritage	
APPROVED	
DERIVED FROM	
TITLE 4-POT S2000 RALLY CALIPER INSTALLATION DRAWING	
DRG NO.	CP6831-10CD

B1

INSTALLATION DRAWING

IF THIS DOCUMENT IS PRINTED IN HARDCOPY, IT IS FOR INFORMATION USE ONLY AND THEREFORE IS NOT SUBJECT TO UPDATING CONTROLS. ALWAYS REFER TO SOLIDWORKS VIEWER FOR LATEST ISSUE



THIS DRAWING IS CONFIDENTIAL AND IS SUPPLIED ON THE EXPRESS CONDITION THAT IT SHALL NOT BE LOANED OR COPIED OR DISCLOSED TO ANY OTHER PERSON OR USED FOR ANY OTHER PURPOSE WITHOUT THE WRITTEN CONSENT OF AP RACING LTD.



AP Racing
Wheler Road
Coventry
CV3 4LB
Tel: +44 024 7663 9595
Fax: +44 024 7663 9559
e-mail: sales@apracing.co.uk
Web site: HTTP://www.apracing.com

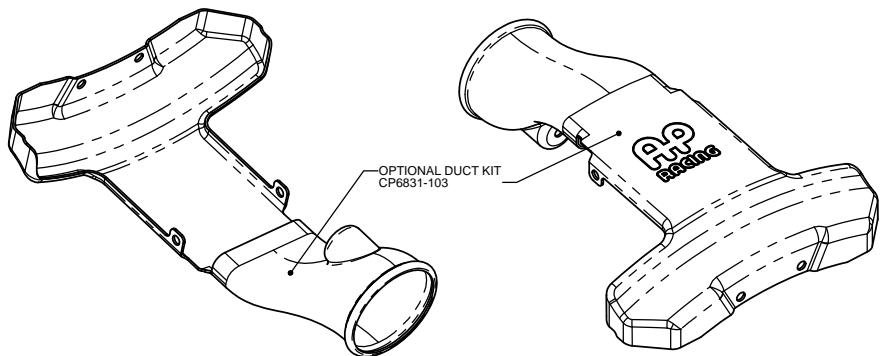

OPTIONAL DUCT KIT
CP6831-103

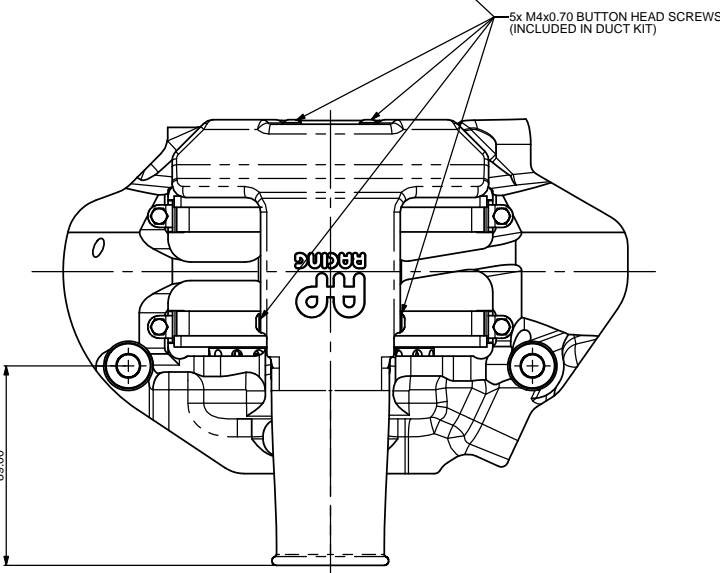
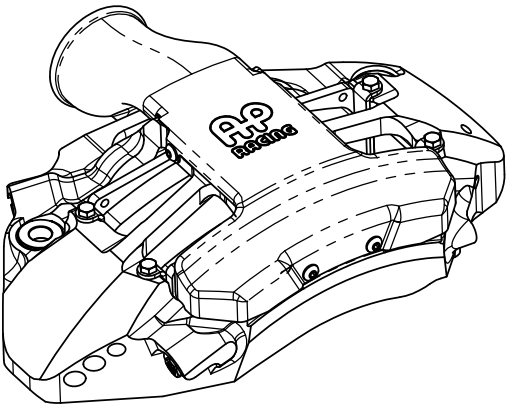
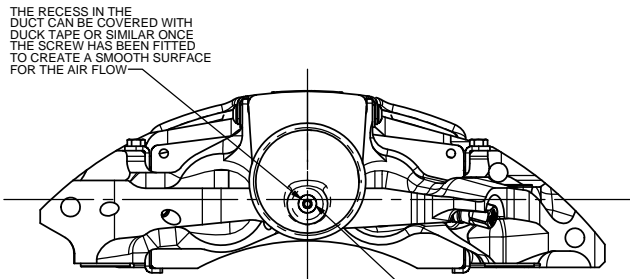
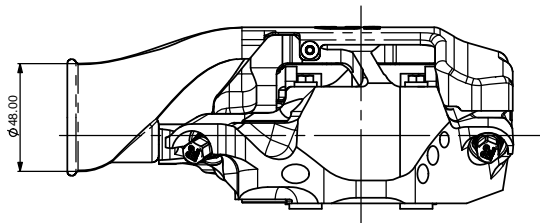
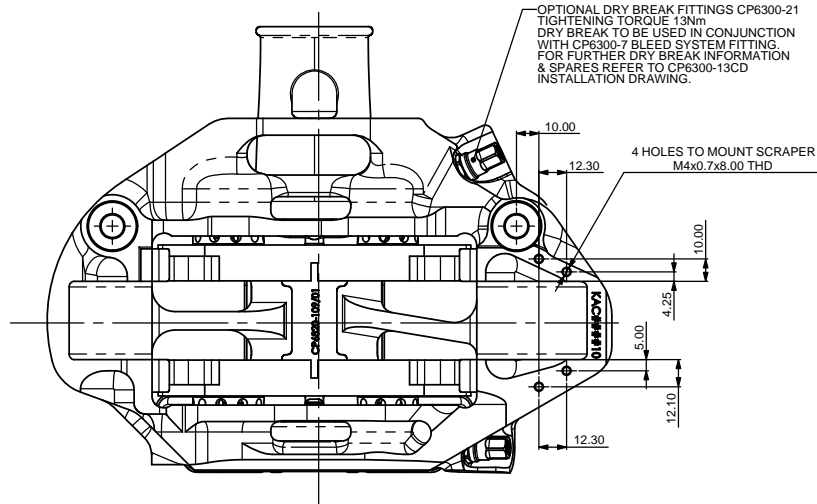

Issue No.	Alterations		Zone	Initials
	Date & No.	Particulars		

SCALE 1:1	SHEET 2 OF 3
DRAWN <i>jheritage</i>	
APPROVED	
DERIVED FROM	
TITLE	
4-POT S2000 RALLY CALIPER INSTALLATION DRAWING	
DRG NO.	CP6831-10CD

B1 INSTALLATION DRAWING

IF THIS DOCUMENT IS PRINTED IN HARDCOPY, IT IS FOR INFORMATION USE ONLY AND THEREFORE IS NOT SUBJECT TO UPDATING CONTROLS. ALWAYS REFER TO SOLIDWORKS VIEWER FOR LATEST ISSUE



FIRST ANGLE PROJECTION

THIS DRAWING IS CONFIDENTIAL AND IS SUPPLIED ON THE EXPRESS CONDITION THAT IT SHALL NOT BE LOANED OR COPIED OR DISCLOSED TO ANY OTHER PERSON OR USED FOR ANY OTHER PURPOSE WITHOUT THE WRITTEN CONSENT OF AP RACING LTD.



AP Racing
 Wheler Road
 Coventry
 CV3 4LB
 Tel: +44 024 7663 9595
 Fax: +44 024 7663 9559
 e-mail: sales@apracings.co.uk
 Web site: HTTP://www.apracings.com

© AP Racing Ltd. 2005

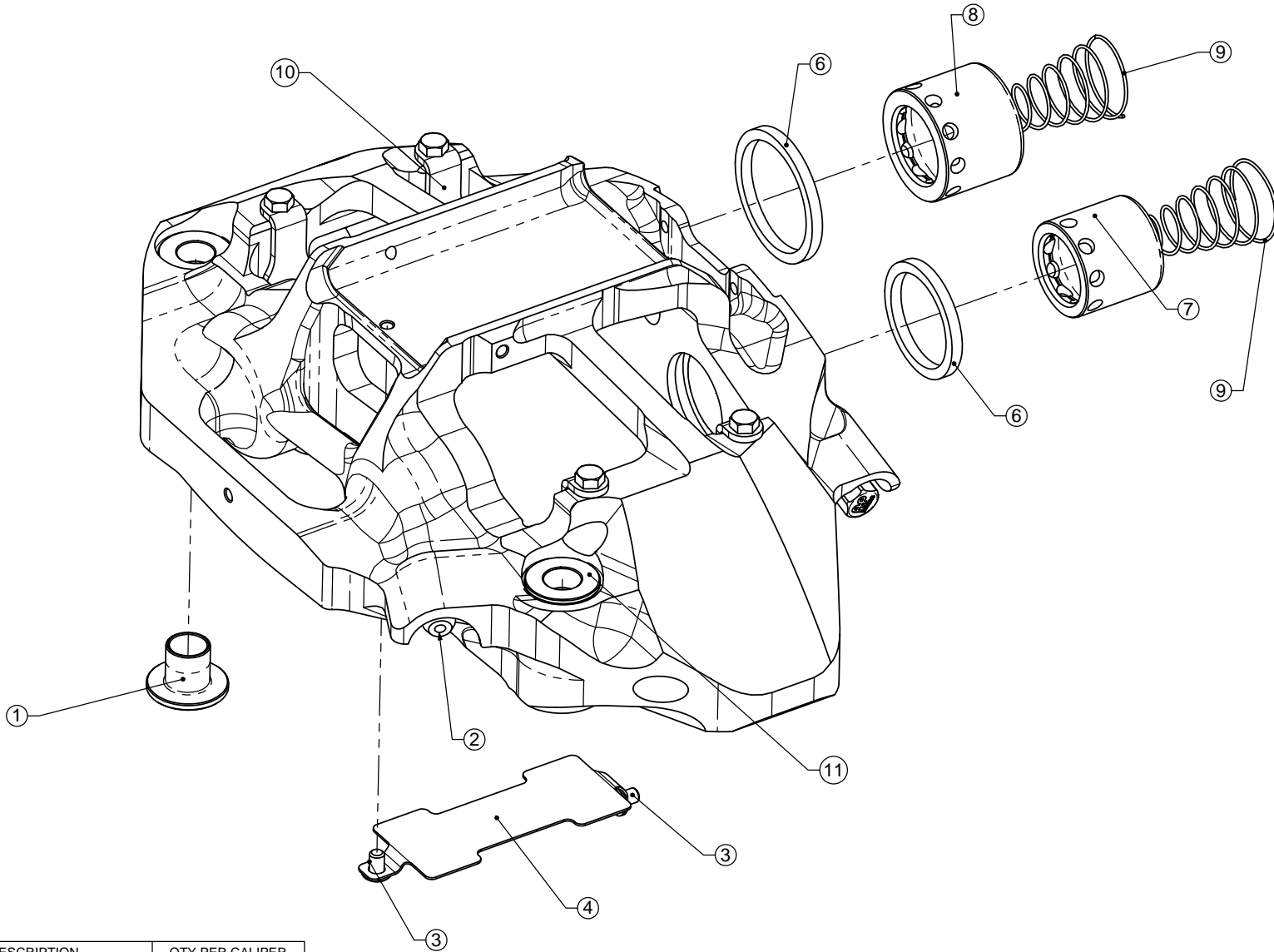

REF	PART NO.	DESCRIPTION	QTY PER CALIPER
1	CP6830-103	LOWER MTG BOSS	2
2	CP3880-1	M10 BLEED SCREW KIT	1
3	CP3355-114	M4x0.7 BUTTON HEAD SCREW	2
4	CP6820-109	PAD RETAINER WEARPLATE	1
5	CP4028-114	M4x0.7 HEX HEAD BOLT	4
6	CP4518-CE	HIGH TEMP SEAL KIT	1
7	CP6821-105	1 1/16" SST PISTON	2
8	CP6821-104	1 1/4" SST PISTON	2
9	CP2632-113	4lb AKB SPRING	4
10	CP6820-113	PAD ABUTMENT WEARPLATE	4
11	CP6720-162	UPPER MTG BOSS	2

Issue No.	Alterations		Zone	Initials
	Date & No.	Particulars		

SCALE 1:2 SHEET 3 OF 3

DRAWN *jheritage*
 APPROVED
 DERIVED FROM

TITLE
**4-POT S2000 RALLY CALIPER
 INSTALLATION DRAWING**
 DRG NO. CP6831-10CD